

This document has been downloaded from:



The largest resource for amusement machines
documentation on the world wide web!



FLIPPERSPILL.COM

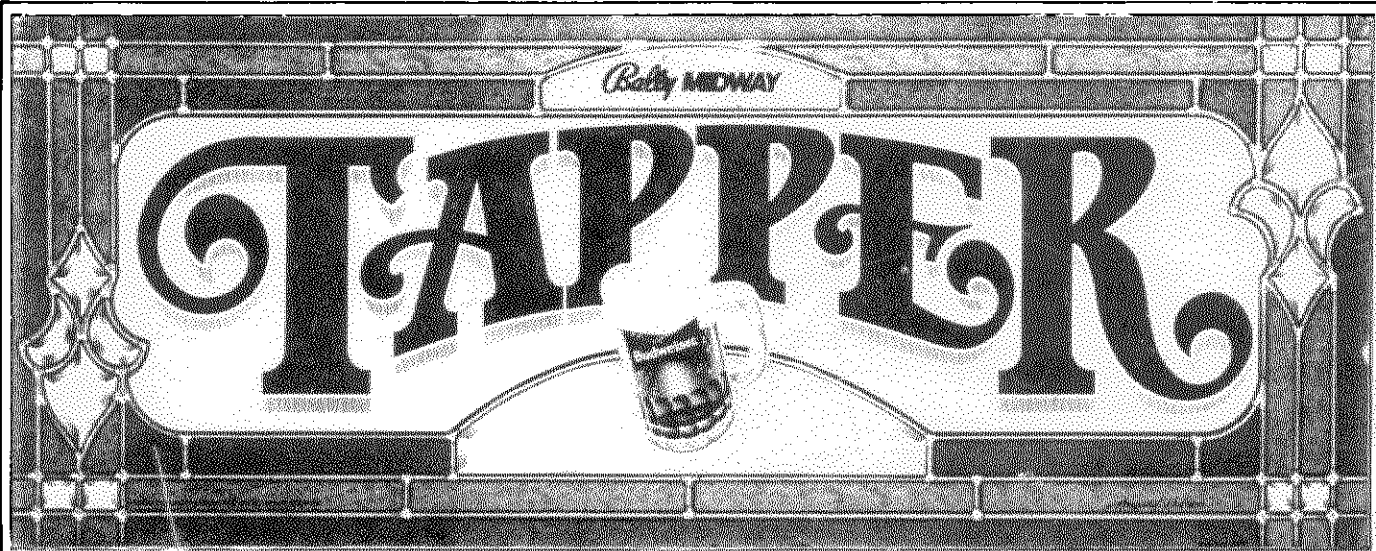

Parts and Operating Manual

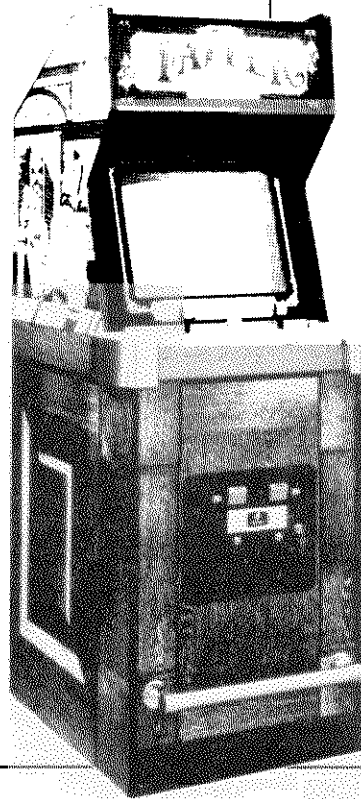

Bally

MIDWAY MFG. CO.

10601 W. Belmont Avenue
Franklin Park, Illinois 60131
U.S.A.



Phone: (312) 451-9200 Cable Address: MIDCO Telex No.: 72-1596

WARNING

**THIS GAME MUST BE GROUNDED. FAILURE TO DO SO MAY
RESULT IN DESTRUCTION TO ELECTRONIC COMPONENTS.**

WARNING: This equipment generates, uses, and can radiate radio frequency energy and if not used in accordance with the instructions manual, may cause interference to radio communications. It has been tested and found to comply with the limits for a CLASS A computing device pursuant to SUBPART J of PART 15 of FCC RULES, which are designed to provide reasonable protection against such interference when operated in a commercial environment. Operation of this equipment in a residential area is likely to cause interference in which case the user at his own expense will be required to take whatever measures may be required to correct the interference.

ELECTRICAL BULLETIN: FOR ALL APPARATUS COVERED BY THE CANADIAN STANDARDS ASSOCIATION (CSA) STANDARD C22.2 NO. 1, WHICH EMPLOYS A SUPPLY CORD TERMINATED WITH A POLARIZED 2-PRONG ATTACHMENT PLUG.

CAUTION: TO PREVENT ELECTRIC SHOCK DO NOT USE THIS (POLARIZED) PLUG WITH AN EXTENSION CORD, RECEPTACLE OR OTHER OUTLET UNLESS THE BLADES CAN BE FULLY INSERTED TO PREVENT BLADE EXPOSURE.

ATTENTION: POUR PREVENIR CHOCS ELECTRIQUES NE PAS UTILISER CETTE FICHE POLARISEE AVEC UN PROLONGATEUR, UNE PRISE DE COURANT OU UNE AUTRE SORTIE DE COURANT, SAUF SI LES LAMES PEUVENT ETRE INSEREES A FOND SANS EN LAISSER AUCUNE PARTIE A DECOUVERT.

Bally MIDWAY

Invites You To Use

**OUR TOLL FREE NUMBERS FOR
SERVICE INFORMATION CONCERNING THIS GAME, OR ANY
OTHER BALLY MIDWAY GAME YOU NOW HAVE ON LOCATION.**

**CALL US FOR PROMPT, COURTEOUS
ANSWERS TO YOUR PROBLEMS.**

VIDEO → Continental U.S. 1-800-323-7182

PINBALL → Continental U.S. 1-800-323-3555

Bally MIDWAY

10601 West Belmont Avenue, Franklin Park, Illinois, 60131

phone (312) 451-9200

© COPYRIGHT MCMLXXXIV BY BALLY MIDWAY MFG. CO.

ALL RIGHTS RESERVED

NO PART OF THIS PUBLICATION MAY BE REPRODUCED BY ANY MECHANICAL, PHOTOGRAPHIC, OR ELECTRONIC PROCESS, OR IN THE FORM OF A PHONOGRAPHIC RECORDING, NOR MAY IT BE TRANSMITTED, OR OTHERWISE COPIED FOR PUBLIC OR PRIVATE USE, WITHOUT PERMISSION FROM THE PUBLISHER. THIS MANUAL IS FOR SERVICE USE ONLY, AND NOT FOR GENERAL DISTRIBUTION. FOR PERMISSION REQUESTS, WRITE: BALLY MIDWAY MFG. CO., 10601 W. BELMONT AVE., FRANKLIN PARK, IL 60131

Printed in U.S.A.

TAPPER

GAME OPERATION

ATTRACT MODE

1. The Attract mode starts:
 - ☐ Just after power has been turned on to the game. (Self-Test switch is in the "OFF" position.)
 - ☐ After a Self-Test has been completed and there are no more credits left in the games memory.
 - ☐ After a play has been finished, the score was not high enough to put the game into the High Score/Initial mode, and there are no more credits left in the games memory.
 - ☐ After the High Score/Initial mode when there are no more credits left in its memory.
 - ☐ No matter where the game is in the Attract mode sequence, it will immediately go to the Ready-To-Play mode display as soon as a game has been paid for.

READY-TO-PLAY MODE

1. The Ready-To-Play mode starts when enough coins have been accepted for a 1 player game. Additional coins may be deposited for a 2 player game.
2. The Ready-To-Play mode ends when the "START" button is pressed.

PLAY MODE

1. The Play mode begins when the "START" button is pressed.
2. The Play mode ends when all of your BAR TENDERS have been eliminated. When this happens, "GAME OVER" is written across the monitor screen.

HIGH SCORE/INITIAL MODE:

If your score was high enough to become one of the ten best scores, the game will go into the High Score/Initial mode immediately after the "GAME OVER" display. If your score is not high enough to cause the game to go into the High Score/Initial mode, it will either go to the Attract mode (if there are no more credits left in its memory) or into the Ready-To-Play mode (if there are still credits left in its memory).

Follow the ON-SCREEN instructions to enter your initials next to your score in the league of the best ten players to date.

After the High Score/Initial mode, the game will either go to the Attract mode (if there are no more credits left in its memory) or into the Ready-To-Play mode (if there are still credits left in its memory).

T A P P E R **S C O R I N G**

DESCRIPTION	POINTS AWARDED	NOTES
PICK UP TIP	1500 POINTS	
GET DRINKERS OUT OF DOOR		
	50 POINTS	FOR EVERY COWBOY
	75 POINTS	FOR EVERY SPORTS PERSON
	100 POINTS	FOR EVERY PUNK ROCKER
	150 POINTS	FOR EVERY SPACE CREATURE
CATCH AN EMPTY MUG	100 POINTS	FOR EACH ONE CAUGHT
COMPLETING A RACK	1000 POINTS	
COMPLETING BONUS RACK	3000 POINTS	

TAPPER											
OPTION SWITCH SETTINGS											
//////////////////// SWITCH NO. 1 - AT B 3 - LOCATED ON SOUND I/O P.C. BOARD //////////////////////											
DURING GAME PLAY:	SW#1 NOT USED	SW#2 NOT USED	SW#3	SW#4 NOT USED	SW#5 NOT USED	SW#6 NOT USED	SW#7	SW#8 NOT USED	SW#9 NOT USED	SW#10	
ATTRACT MODE SOUNDS ON **ATTRACT MODE SOUNDS OFF	ON OFF										
COCKTAIL MODEL GAME **UPRIGHT MODEL GAME	ON OFF										
FREEZE VIDEO **NORMAL OPERATION	ON OFF										
//////////////////// SWITCH NO. 3 - AT D 14 - LOCATED ON SOUND I/O P.C. BOARD //////////////////////											
**NORMAL OPERATION SOUND I/O DIAGNOSTIC MODE	SW#1 OFF ON	*SW#2	*SW#3	*SW#4							
**NORMAL OPERATION RAM/ROM TEST INDICATES TEST RESULTS VIA YELLOW L E D ON SOUND I/O BOARD: FAST FLASH = BAD ROM SLOW FLASH = BAD RAM	OFF ON										
**NORMAL OPERATION OSCILLATOR TEST	OFF ON										
**NORMAL OPERATION FILTER TEST	OFF ON										
*NO EFFECT IF SW#1 OF SWITCH NO. 3 IS IN THE "OFF" POSITION. **FACTORY RECOMMENDED SETTINGS.								PART NO. M051-00A11-A007			

THE REMAINDER OF YOUR NEW GAME'S MOST COMMON OPTION SETTINGS ARE CONDUCTED DURING THE
MACHINE SETUP PORTION OF THE SELF-TEST MODE.

NO. 0A11 - TAPPER UPRIGHT - FRONT

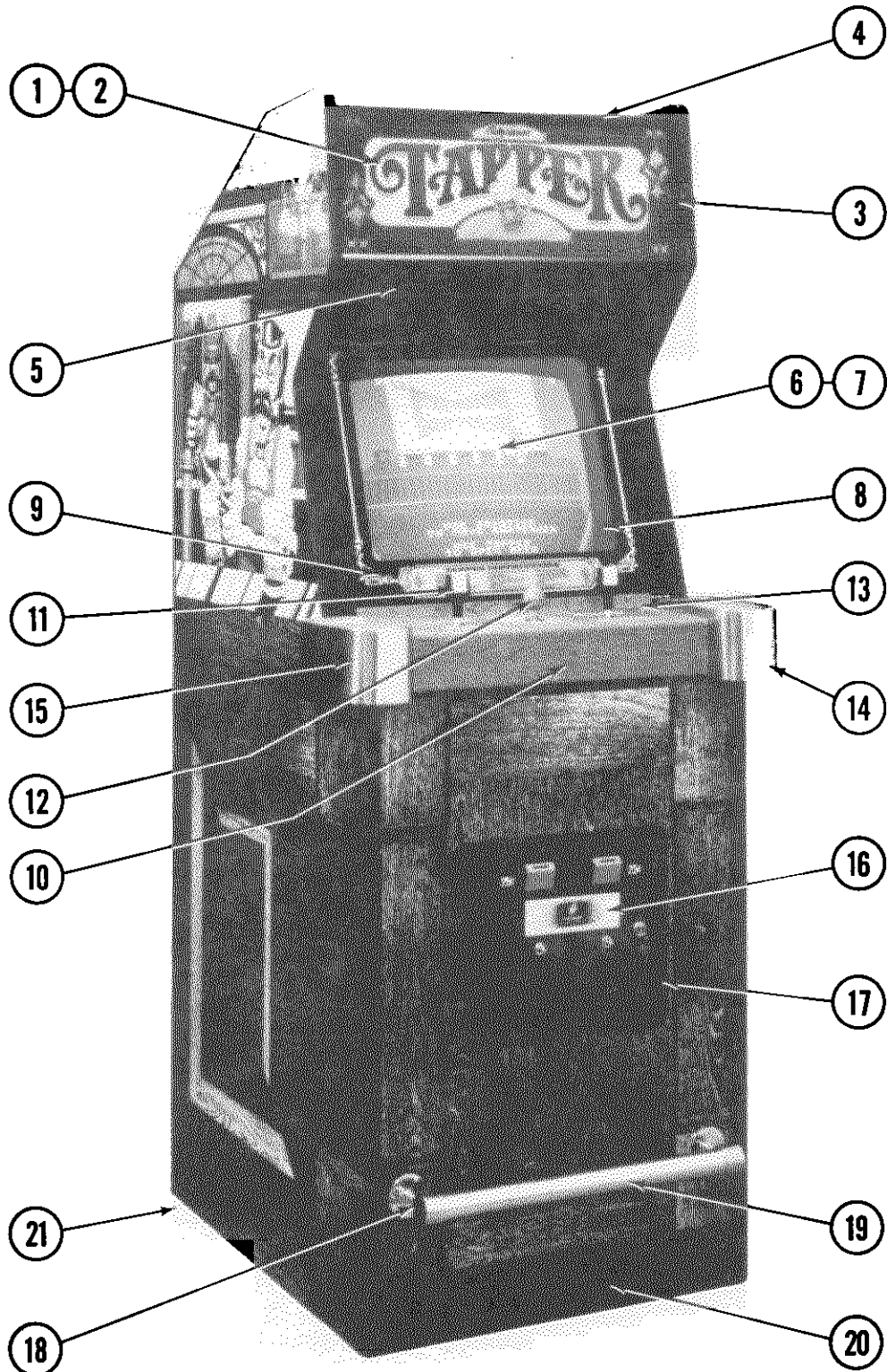

NO. 0A11 - TAPPER UPRIGHT - FRONT PARTS LIST

ORDER BY PART NUMBER ONLY

ITEM	PART NO.	DESCRIPTION
1	0A11-00900-00XF	HEADER GLASS
2	A595-00011-0000	FLUORESCENT HEADER LIGHT ASSY.
3	0537-00903-0055	GLASS CHANNEL - 7-7/8" LG. (2 REQ'D)
4	0574-00903-0100	HEADER RETAINING BRKT. (2 REQ'D)
	0017-00101-0138	#8x5/8 TORX PAN HD. TAMPER PROOF SCR. (10 REQ'D)
5	0017-00009-0393	BLACK SPEAKER GRILLE W/SLOTS (2 REQ'D)
	0017-00003-0430	6"x9" SPEAKER - 4 OHM, 10W. (2 REQ'D)
	0017-00003-0461	6"x9" SPEAKER - 4 OHM, 15W. (2 REQ'D)
	0017-00101-0127	#8-32x1-1/2 CARRIAGE BOLT (8 REQ'D)
	0017-00103-0061	#8-32 HEX NUT W/SEMS (8 REQ'D)
6	A311-00002-0000	19" HORIZ. MONITOR ASSY.
7	0333-00902-0000	PLEXI-DIFFUSER
	0508-00901-0000	PLEXI-GLASS MTG. CLIPS (4 REQ'D)
	0017-00101-0141	#8x11/16 UNSLOT. HEX HD. SCREW (4 REQ'D)
8	0017-00042-0314	19" BEZEL - INJECTION MOLDED
9	0A11-00901-00XF	MAIN VIEWING GLASS
	0A11-00902-0100	GLASS HOLDER - RIGHT
	0A11-00902-0200	GLASS HOLDER - LEFT
10	AA11-00016-0000	CONTROL SHELF PLATE ASSY.
	0A11-00904-0000	DECORATIVE OVERLAY
	0A11-00100-01XF	CONTROL SHELF MTG. BRKT. - RIGHT
	0A11-00100-02XF	CONTROL SHELF MTG. BRKT. - LEFT
	0555-00901-0000	PLASTIC LOCATING PIN (4 REQ'D)
	0017-00009-0534	BASSICK CLAMP (2 REQ'D)
	0017-00101-0141	#8x11/16 UNSLOT. HEX HD. SCREW (8 REQ'D)
11	AA11-00015-0000	HANDLE CONTROL ASSY. (2 REQ'D)
12	A982-00017-0000	CONTROL ASSY.
13	0017-00032-0106	SMALL RED PUSH BUTTON SWITCH (2 REQ'D)
14	0A11-00902-0100	GLASS HOLDER - RIGHT
15	0A11-00902-0200	GLASS HOLDER - LEFT
16	A982-00014-0000	DOUBLE COIN DOOR & CABLE ASSY.
17	0090-00002-04BK	LARGE COIN DOOR FRAME
	0017-00101-0121	#6-32x5/16 PHIL. TRS. HD. SCR. (3 REQ'D)
		(MOUNTS COIN DOOR TO FRAME)
	A950-00004-0000	COIN BOX ASSEMBLY
	A950-00006-0100	WIRE COIN BOX CRADLE ASSY.
	0950-00105-0000	COIN BOX COVER
	0950-00104-0000	COIN BOX HANDLE
	0950-00101-0000	COIN DEFLECTOR (2 REQ'D)
	0950-00900-0000	LARGE PLASTIC COIN BOX
	0950-00103-0000	COIN BOX DIVIDER - OPTIONAL
	0017-00101-0142	1/4-20x1-3/8 BLACK RND. HD. BOLT (4 REQ'D)
	0017-00104-0014	7/8" DISH WASHER (4 REQ'D)
	0017-00103-0018	1/4-20 HEX NUT (4 REQ'D)
18	0A11-00106-0000	BRASS END POST (2 REQ'D)
19	0017-00009-0558	BRASS RAIL
20	0935-00906-0100	KICK PLATE - 23" LG.
21	0017-00102-0048	3/8-16x2" LEG LEVELERS (4 REQ'D)
	0017-00103-0026	3/8-16 LEG LEVELER HEX NUTS (4 REQ'D)

NO. 0A11 - TAPPER UPRIGHT - REAR ACCESS

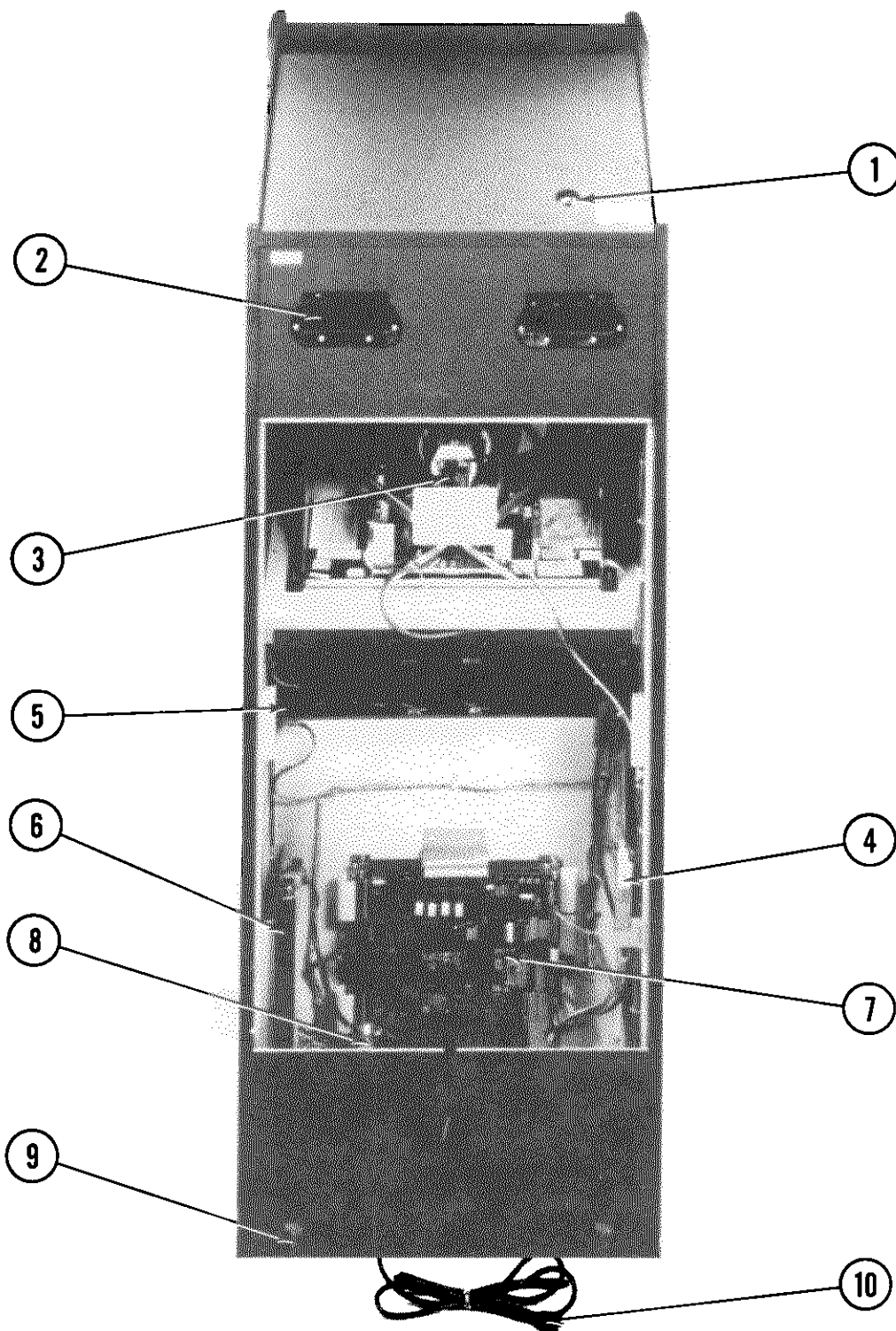

NO. 0A11 - TAPPER UPRIGHT - REAR ACCESS PARTS LIST

ORDER BY PART NUMBER ONLY

ITEM	PART NO.	DESCRIPTION
1	A945-00038-0000	ON-OFF SWITCH & PLATE ASSY.
2	0894-00916-0000	PLASTIC PULL & VENT (2 REQ'D)
	0017-00101-0141	#8x11/16 UNSLOT. HEX HD. M.S. (8 REQ'D)
3	0017-00003-0339	ELECTROHOME - 19" COLOR MONITOR (OR)
3	0017-00003-0439	WELLS-GARDNER - 19" COLOR MONITOR (OR)
3	0017-00003-0454	ZENITH - 19" COLOR DUAL SYNC MONITOR
	0636-00101-0000	MONITOR RAIL (2 REQ'D)
	0555-00901-0000	PLASTIC LOCATING PINS (4 REQ'D)
	0017-00101-0141	#8x11/16 UNSLOT. HEX HD. M.S. (8 REQ'D)
4	A088-00016-0000	INTERLOCK SWITCH & SPRING BRKT. ASSY.
	0303-00904-0000	INTERLOCK SWITCH COVER
5	A084-90910-F000	DUAL POWER AMP ASSY.
6	A084-90412-D000	POWER SUPPLY P.C. ASSY. - 125VA.
	0624-00902-0100	P.C. SUPPORT BRKT. - 12" LG. (2 REQ'D)
	0624-00902-0500	P.C. SUPPORT BRKT. - 6-1/2" LG. (2 REQ'D)
	0017-00101-0141	#8x11/16 UNSLOT. HEX HD. M.S. (10 REQ'D)
	0017-00104-0037	#8 WASHER (10 REQ'D)
7	AA11-00007-0000	CARD RACK W/BOARDS ASSY.
8	A945-00020-0000	POWER CHASSIS ASSY. -125VA., 115V.
9	A961-00007-0000	CASTER ASSEMBLY (2 REQ'D)
10	A945-00019-0000	LINE CORD ASSY. -115V.
ADDITIONAL PARTS LIST		
	A097-00009-0000	BACK DOOR LOCK ASSY.
	0017-00009-0490	5-5/8" SQR. BACK DOOR VENT GRILLE (4 REQ'D)
7	AA11-00007-0000	CARD RACK W/ BOARDS ASSY.
	A084-90913-AA11	PROG. SUPER SOUND I/O P.C. BRD. ASSY.
	A639-00060-0000	SHIELD & BARRIER ASSY.
	0017-00101-0134	#6-32x1/4" PHIL. RND. HD. M.S. (4 REQ'D)
	A084-91490-AA11	PROG. C.P.U. P.C. BOARD ASSY.
	A358-00016-0000	SHIELD & SPACER ASSY. - INNER
	A084-91464-AA11	PROG. SUPER VIDEO GENERATOR P.C.B. ASSY.
	A358-00017-0000	SHIELD & SPACER ASSY. - OUTER
	0017-00101-0153	#6-32x1" PHIL. RND. HD. M.S. (8 REQ'D)

NO. 0A11 - TAPPER UPRIGHT - HANDLE CONTROL ASSY.

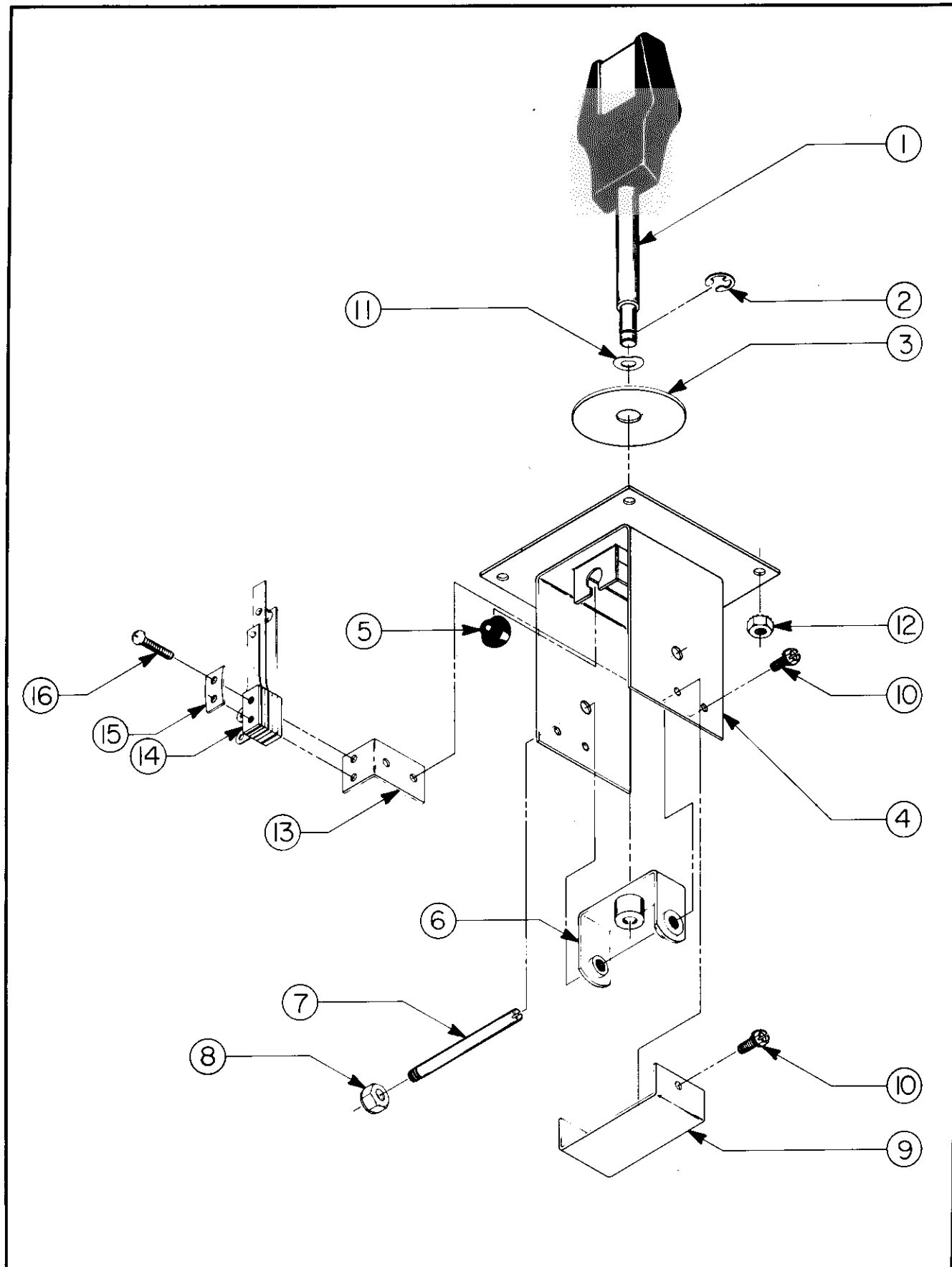

NO. 0A11 - TAPPER UPRIGHT - HANDLE CONTROL ASSY. - PARTS LIST

ORDER BY PART NUMBER ONLY

ITEM	PART NO.	DESCRIPTION
1	AA11-00012-0000	HANDLE & SHAFT ASSY.
2	0017-00100-0025	1/4" E-RING
3	0852-00106-0000	FOLLOWER PLATE
4	AA11-00013-0000	TOP PLATE TO MAIN CONTROL BRKT. ASSY.
5	0017-00041-0616	RUBBER BUMPER - 90 DUROMETER (2 REQ'D)
6	A866-00027-0000	PIVOT BRKT. HUB & BEARING ASSY.
7	0852-00701-00XF	PIVOT PIN
8	0017-00103-0011	#10-32 LOCK NUT
9	0508-00112-00XF	BRACE - MAIN BRKT.
10	0017-00101-0555	#6-32x5/16 SLT. HEX HD. SCREW (3 REQ'D)
11	0017-00104-0116	SPRING WASHER
12	0017-00103-0061	#8-32 LOCK NUT W/SEMS (4 REQ'D)
13	0353-00108-0000	SWITCH BRKT.
14	A353-00020-0000	LEAF SWITCH ASSY.
15	0020-00202-0000	SWITCH PLATE
16	0017-00101-0527	#5-40x5/8 PHIL. RND. HD. M.S. (2 REQ'D)
	0A11-00905-0000	HANDLE OVERLAY (NOT SHOWN)

NO. 0A11 - TAPPER UPRIGHT - CONTROL ASSY.

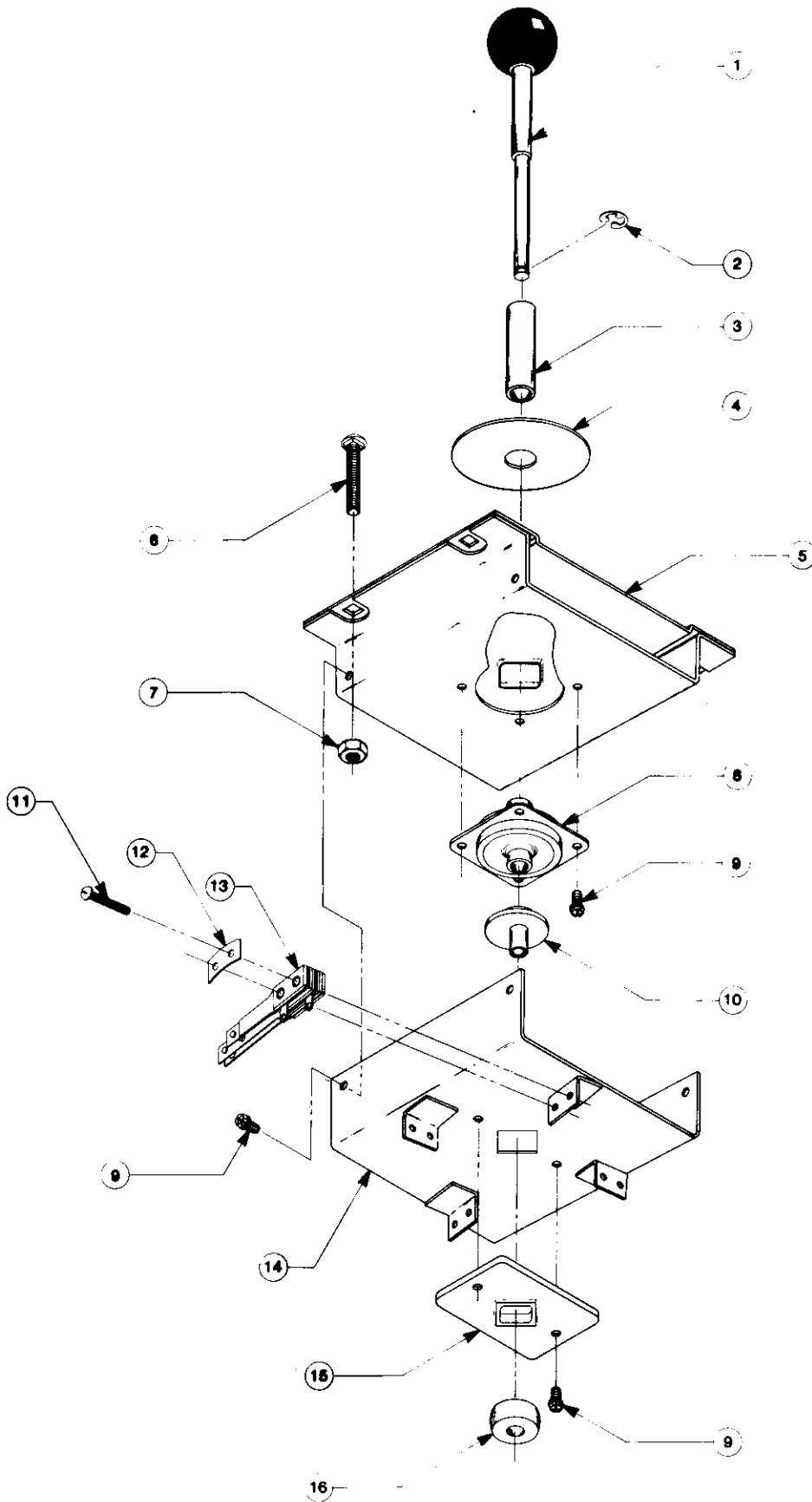

NO. 0A11 - TAPPER UPRIGHT - CONTROL ASSY. - PARTS LIST

ORDER BY PART NUMBER ONLY

ITEM	PART NO.	DESCRIPTION
1	A932-00022-0000	BALL & SHAFT ASSEMBLY
2	0017-00100-0025	1/4 E-RING
3	0921-00702-0000	STOP SPACER
4	0921-00902-0000	SLIDE PLATE
5	A982-00019-0000	PIVOT PLATE WELD ASSY.
6	0017-00101-0637	#8-32 x 1" CARRIAGE BOLT (4 REQ'D.)
7	0017-00103-0061	#8-32 HEX NUT W/SEMS (4 REQ'D.)
8	0932-00902-0000	GROMMET
9	0017-00101-0598	#8-32 x 5/16 SLT. HEX HD. M.S. (10 REQ'D.)
10	0962-00904-0000	SLEEVE
11	0017-00101-0527	#5-40 x 5/8 SLT. RND. HD. SCR. (8 REQ'D.)
12	0020-00202-0000	SWITCH PLATE (4 REQ'D.)
13	A932-00009-0000	SWITCH ASSEMBLY (4 REQ'D.)
14	A932-00012-0000	STOP PLATE & SWITCH BRKT. ASSY.
15	0932-00905-0000	WEAR PLATE
16	0921-00700-0000	ACTUATOR

FRONT DOOR ASSEMBLY — U.S.A. 25¢

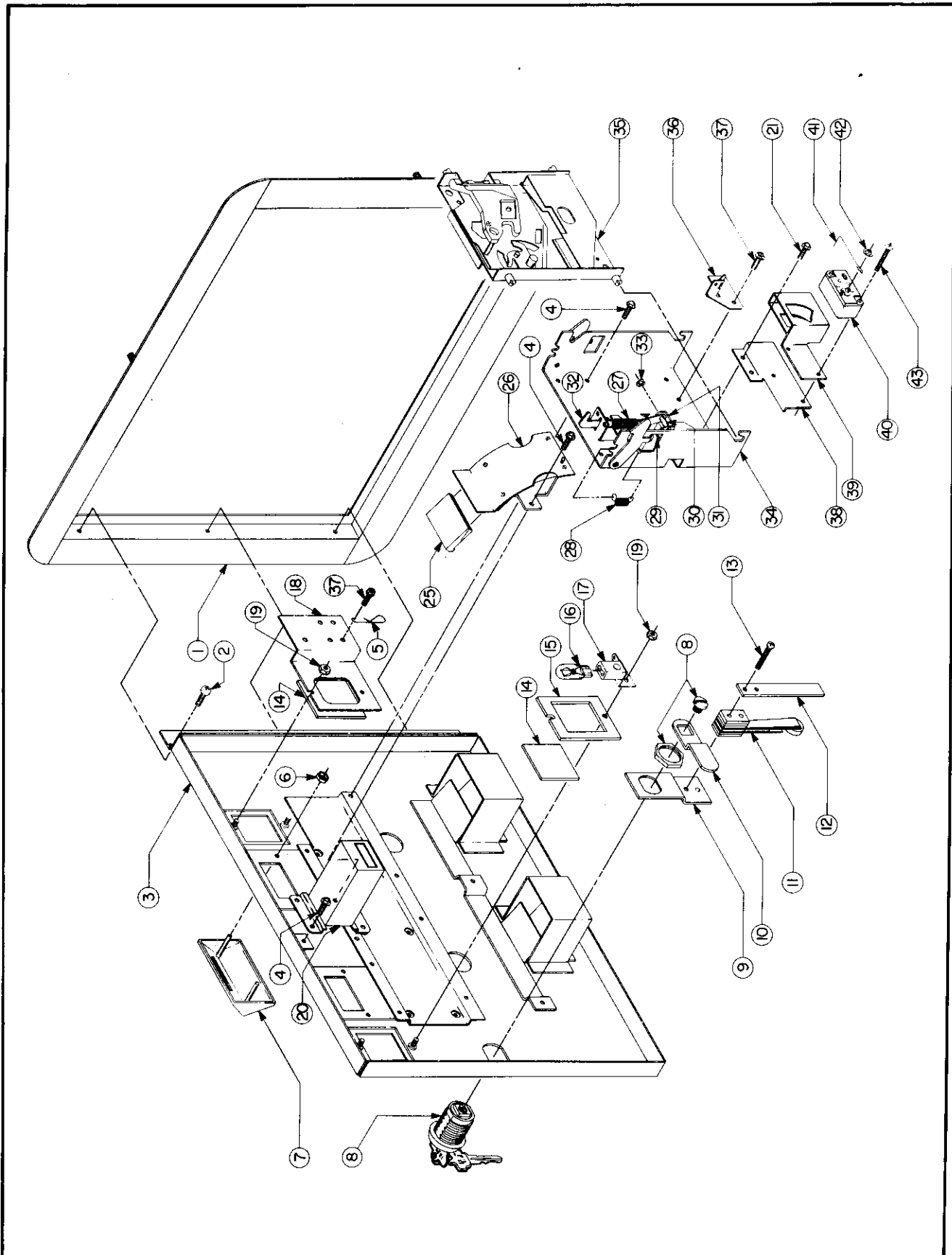

FRONT DOOR ASSEMBLY — U.S.A. 25¢ — PARTS LIST

ORDER BY PART NUMBER ONLY

ITEM	PART NO.	DESCRIPTION
1	0090-00002-04BK	DOUBLE ENTRY COIN DOOR FRAME
2	0017-00101-0121	#6-32 x 5/16 PHIL. TRS. HD. SCR. (3 REQ'D.)
3	A090-00073-02BK	DOUBLE ENTRY COIN DOOR W/DRESS PLATE
4	0017-00101-0123	#8 x 1/4 UNSLOT. HEX HD. SCREW (12 REQ'D.)
5	0017-00007-0019	KEY HOOK
6	0017-00103-0059	PUSH NUT (4 REQ'D.)
7	0090-00912-0000	COIN ENTRY PLATE — 25¢ (2 REQ'D.)
8	A097-00005-0000	DOOR LOCK & KEY W/SCREW & NUT (OR)
8	A097-00006-0000	DOOR LOCK & KEY W/SCREW & NUT
9	0090-00128-00XF	DOOR TILT SWITCH BRKT.
10	0017-00005-0225	DOOR CAM
11	A090-00095-0000	DOOR TILT SWITCH
12	0090-00126-03XF	SWITCH BACK-UP PLATE
13	0017-00101-0525	#5-40 x 9/16" PHIL. HD. M.S. (2 REQ'D.)
	A090-00096-0000	DOOR TILT SWITCH & BRKT. ASSY. (ITEMS 9 & 11 THRU 13)
14	0090-00903-9500	25¢ WINDOW (2 REQ'D.)
15	0090-00143-00XF	COIN PLEX RETAINER
16	0017-00003-0219	12 VOLT LAMP — G.E. #194 (2 REQ'D.)
17	0017-00031-0048	WEDGE SOCKET W/BRKT. (2 REQ'D.)
18	A090-00100-0000	BRKT. ASSY.
19	0017-00103-0084	#6-32 HEX NUT W/SEMS (4 REQ'D.)
20	A090-00089-0000	COIN METER W/DIODE
21	0017-00101-0124	#6 x 1/4 UNSLOT. HEX HD. SCR. (4 REQ'D.)
25	0090-00911-0000	INSULATOR (2 REQ'D.)
26	A090-00112-0000	COIN CHUTE & TOP ASSY. (2 REQ'D.)
27	0010-00134-0000	SPRING
28	0010-00181-0000	SPRING
29	0017-00007-0083	1/8 x 1-5/8 ROLL PIN
30	0090-00129-00XF	PIVOT POST
31	0090-00167-00XF	PIVOT LEVER
32	0090-00182-00XF	REJECT LEVER
33	0017-00100-0018	E-RING
	A090-00088-0000	REJECT LEVER ASSY. (2 REQ'D.) (ITEMS 30 THRU 33)
34	A090-00105-0000	COIN ACCEPTOR FRAME ASSY. (2 REQ'D.)
35	0017-00005-0003	COIN ACCEPTOR W/STRING CUTTER (2 REQ'D.) (OR)
35	0017-00005-0211	COIN ACCEPTOR W/ANTI STRING DEVICE (2 REQ'D.) (OR)
35	0017-00005-0214	COIN ACCEPTOR W/STRING CUTTER (2 REQ'D.)
36	A090-00064-0000	ANTI-PENNY DEVICE
37	0017-00101-0099	#6 x 1/4 SLT. HEX HD. M.S. (2 REQ'D.)
38	0090-00162-00XF	COIN SWITCH MTG. BRKT.
39	0017-00005-0203	COIN SWITCH CHUTE
40	0017-00005-0195	COIN SWITCH
41	0010-00599-0000	COIN SWITCH WIRE
42	0017-00007-0015	PUSH-ON RING
	A090-00059-0400	COIN SWITCH & WIRE ASSY. (ITEMS 40 THRU 42)
43	0017-00101-0147	#4-40 x 3/4 PHIL. PAN. HD. M.S. (2 REQ'D.)
	A090-00077-0000	COIN GUIDE & SWITCH ASSY. (ITEMS 38 THRU 43)

— POWER CHASSIS ASSY. — 125VA., 115V.

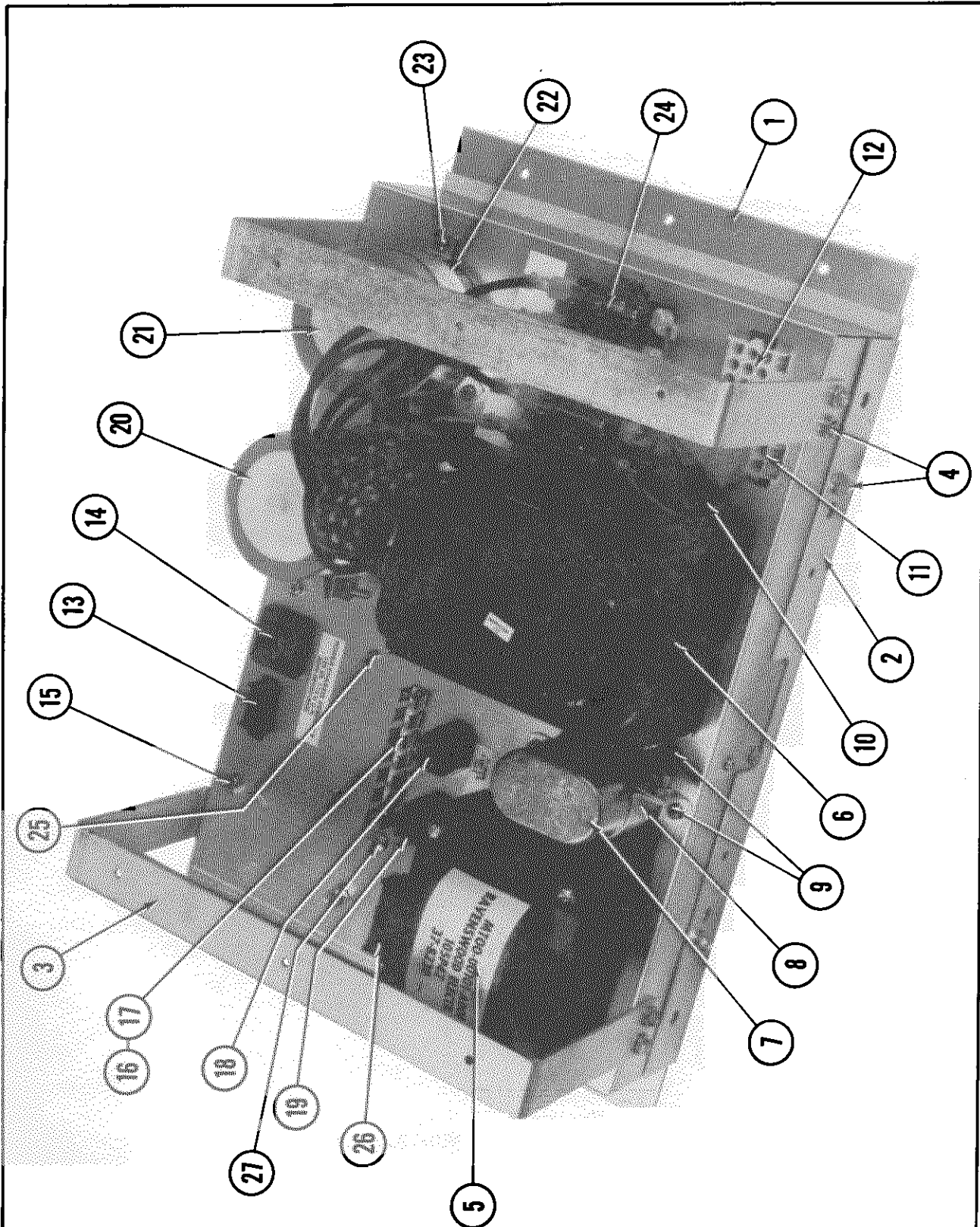

NOTE: DRAWING MAY DIFFER SLIGHTLY FROM ACTUAL ASSEMBLY

POWER CHASSIS ASSY.—125VA., 115V.—PARTS LIST

ORDER BY PART NUMBER ONLY

ITEM	PART NO.	DESCRIPTION
1	A945-00046-00XF	CHASSIS & PARTITION ASSY.
2	A945-00029-0100	MTG. PLATE & BARRIER ASSY.
3	0945-00107-01XF	STRAP (2 REQ'D.)
4	0017-00101-0123	#8 x 1/4 UNSLOT. HEX HD. SCR. (12 REQ'D.)
5	MT00-00101-A000	ISOLATION TRANSFORMER W/O SHIELD ASSY. — 115V., 50/60 HZ.
	0017-00103-0061	#8-32 HEX NUT W/SEMS (4 REQ'D.)
6	MT00-00099-A000	POWER TRANSFORMER ASSY. — 115V., 60 HZ.
	0017-00103-0084	#6-32 HEX NUT W/SEMS (4 REQ'D.)
7	0175-181T4-GXJK	CAPACITOR — 3.5 M.F., 440V.
8	0017-00009-0535	CLAMP
	0017-00101-0565	#6-32 x 7/16 SLT. PAN HD. SCR.
	0017-00103-0084	#6-32 HEX NUT W/SEMS
9	0017-00101-0067	#6 x 3/8 PHIL. PAN HD. SCR. (11 REQ'D.)
10	0945-00902-0000	SNAP BUSHING (3 REQ'D.)
11	0017-00021-0297	2 POSITION CONNECTOR
12	A945-00030-0100	CONNECTOR & CABLE ASSY. #1
13	A945-00030-0200	CONNECTOR & CABLE ASSY. #2
14	A945-00021-0000	CONVENIENCE OUTLET ASSY.
15	0017-00101-0573	#6-32 x 1/2 PHIL. RND. HD. SCR. (2 REQ'D.)
	0017-00103-0084	#6-32 HEX NUT W/SEMS (2 REQ'D.)
	A945-00025-0000	FILTER ASSEMBLY — 125V. — UNDER CHASSIS (NOT SEEN)
16	0017-00021-0510	TERMINAL STRIP
17	0017-00101-0140	#4-40 x 5/16 PHIL. PAN HD. SCR. (2 REQ'D.)
18	0017-00083-0263	SLO-BLO FUSE — 4A., 250V.
19	0017-00003-0005	FUSE — 2A., 250V.
	0017-00003-0444	QUICK CONN. FUSEHOLDER (2 REQ'D.) — FOR ABOVE FUSES
20	0945-00816-1902	CAPACITOR — 100,000 M.F.
21	0945-00816-1901	CAPACITOR — 55,000 M.F.
	0017-00104-0107	#10 FLAT WASHER (4 REQ'D.)
	0017-00103-0081	#10-32 HEX NUT W/SEMS (4 REQ'D.)
22	0017-00009-0422	CLAMP (2 REQ'D.)
	0017-00101-0758	#8-32 x 3/4 PHIL. RND. HD. SCREW (2 REQ'D.)
	0017-00103-0061	#8-32 HEX NUT W/SEMS (2 REQ'D.)
23	0017-00101-0067	#6 x 3/8 PHIL. PAN HD. SCR. (6 REQ'D.)
24	0945-00904-0000	5 POSITION FUSE HOLDER
	0017-00003-0263	SLO-BLO FUSE — 4A., 250V.
	0017-00003-0217	SLO-BLO FUSE — 2.5A., 250V. (2 REQ'D.)
	0017-00003-0007	SLO-BLO FUSE — 3A., 250V. (2 REQ'D.)
	0945-00903-0000	FUSE HOLDER BARRIER
	A945-00022-0000	HEATSINK & DIODE ASSY.
	0017-00101-0067	#6 x 3/8 PHIL. PAN HD. SCR. (2 REQ'D.)
25	0017-00101-0780	#6 x 1/2 PHIL. PAN HD. SCREW (2 REQ'D.)
	0017-00021-0629	5 POSITION TERMINAL STRIP — (UNDER CHASSIS)
	A945-00019-0000	LINE CORD ASSY. — 115V. (NOT SHOWN)
26	A945-00030-0500	CONNECTOR & CABLE ASSY.
27	0017-00101-0660	#10-32 x 3/4 PAN HD. SCREW
	0017-00104-0107	#10 FLAT WASHER
	0017-00103-0081	#10-32 HEX NUT W/SEMS

HEADER FLOURESCENT FIXTUTRE ASSY.

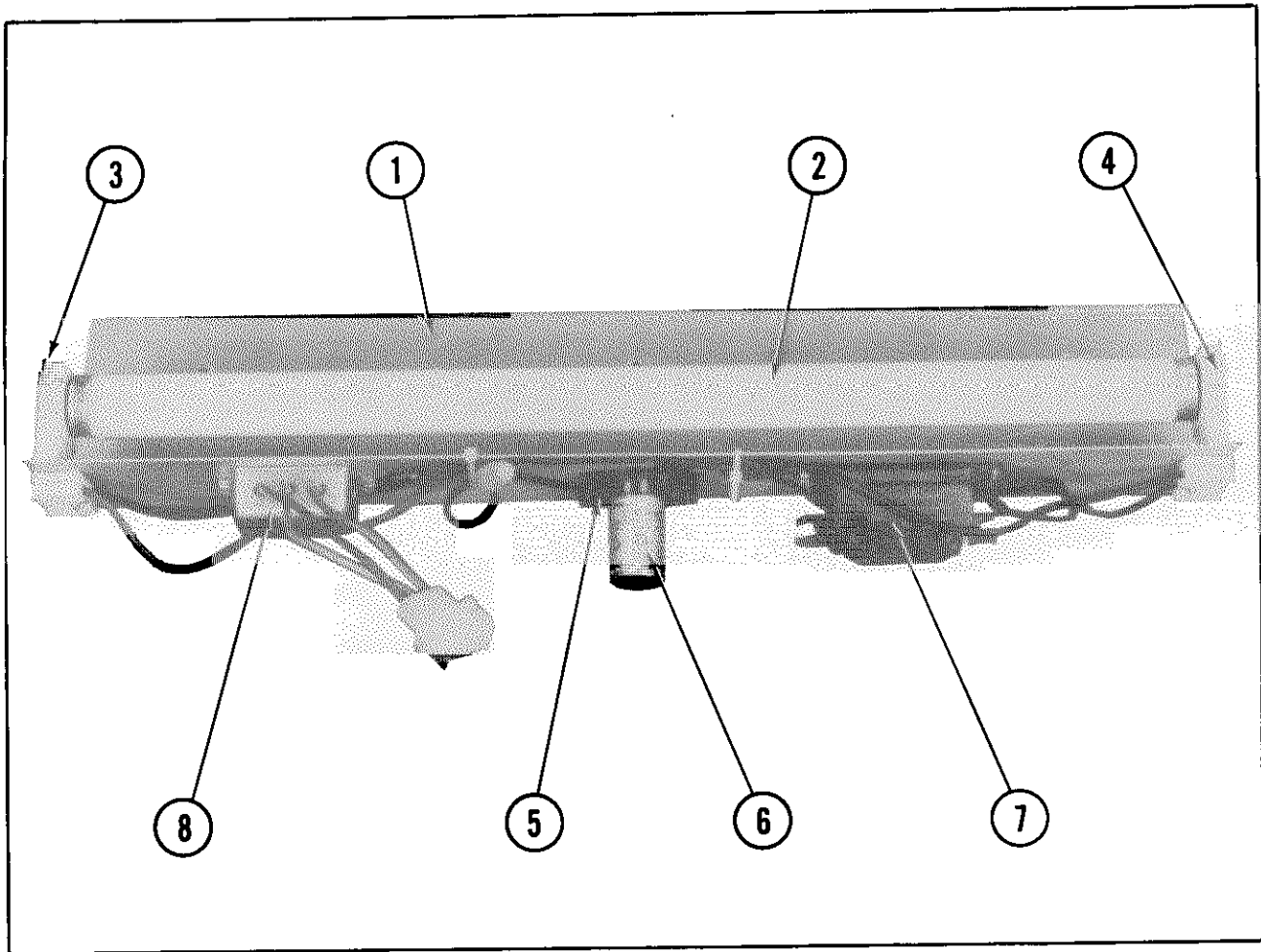

HEADER FLOURESCENT FIXTUTRE ASSY. - PARTS LIST

ORDER BY PART NUMBER **ONLY**

ITEM	PART NO.	DESCRIPTION
1	0595-00105-0000	FLUORESCENT BRKT.
2	0017-00003-0043	18" COOL WHITE FLUORESCENT LAMP
3	0017-00003-0445	LAMP LOCKS (2 REQ'D.)
4	0017-00031-0036	FLUORESCENT SOCKET (2 REQ'D.)
5	0017-00003-0412	FLUORESCENT STARTER HOLDER W/LEADS
	0017-00101-0573	#6-32 x 1/2 PHIL. RND. HD. M.S. (4 REQ'D.)
	0017-00104-0009	#6 EXT. WASHER (4 REQ'D.)
6	0017-00003-0019	FLUORESCENT STARTER
7	0017-00003-0026	BALLAST
	0017-00101-0598	#8-32 x 5/16 SLT. HEX HD. SCR. (4 REQ'D.)
8	A961-00042-0000	LINE FILTER ASSY.

NO. 0A56 - TAPPER COCKTAIL - PARTS LIST

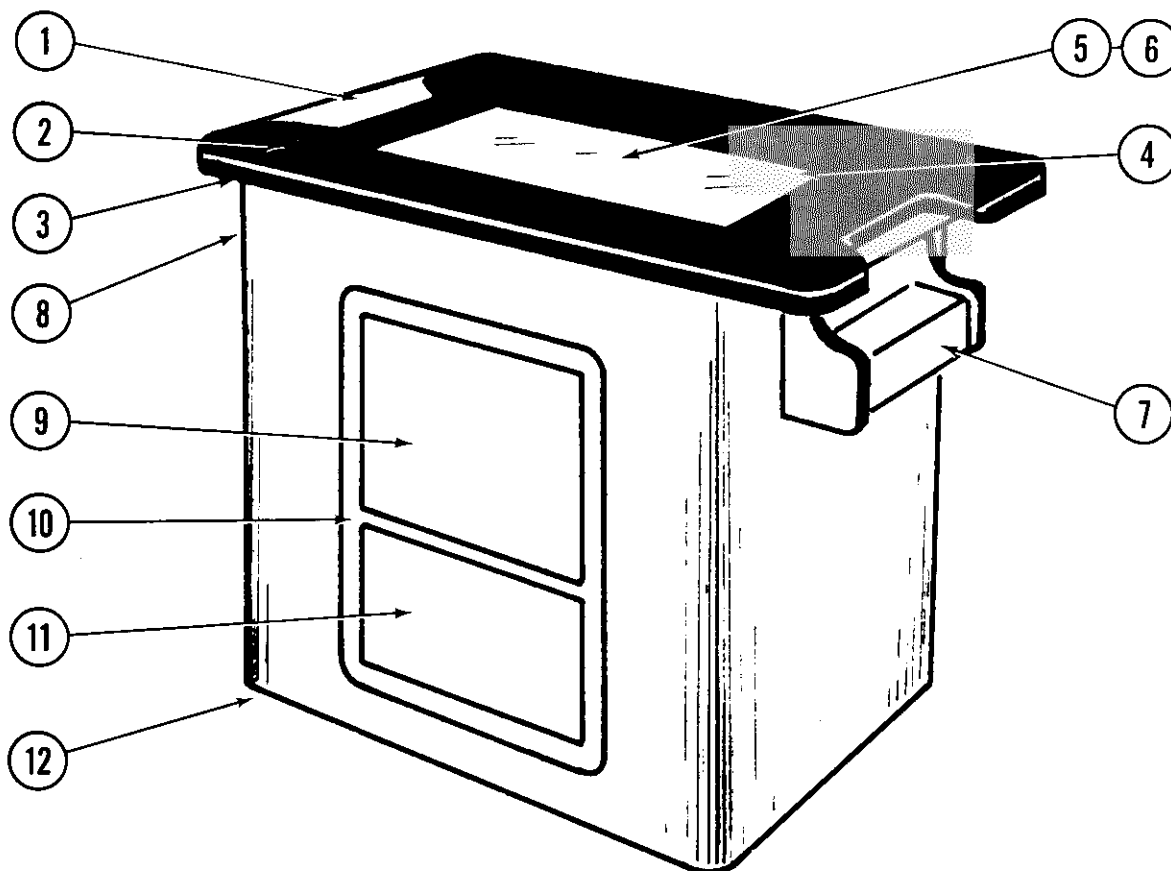

ORDER BY PART NUMBER ONLY

ITEM	PART NUMBER	DESCRIPTION
1	0311-00901-0000	COVER GLASS
2	0A56-00900-0000	DECORATIVE ARTWORK UNDERLAY
3	0311-00101-00XF	CORNER GLASS CLIPS (4 REQ'D)
	0017-00101-0126	#10-32x3/4 HEX BUTTON HD. SCREW (4 REQ'D)
4	0017-00042-0314	19" BEZEL - INJECTION MOLDED
	0311-00100-0000	BEZEL MTG. BRKT. (2 REQ'D)
5	0333-00902-0000	DIFFUSER
	0508-00901-0000	PLEXI-GLASS MTG. CLIPS (4 REQ'D)
	0017-00101-0124	#6x1/4 UNSLOT HEX HD. M.S. (4 REQ'D)
6	0017-00003-0474	ELECTROHOME - 19" COLOR MONITOR (OR)
6	0017-00003-0473	WELLS-GARDNER - 19" COLOR MONITOR
	0311-00109-0000	HORIZONTAL MONITOR MTG. BRKT. (2 REQ'D)
	0311-00902-0000	MONITOR SHIELD
7	AA56-00004-0200	CONTROL SHELF ASSY. - PLAYER #2
	0A56-00901-0200	DECORATIVE OVERLAY - PLAYER #2

MO51-00A56-A009

NO. 0A56 - TAPPER COCKTAIL - PARTS LIST

ORDER BY PART NUMBER ONLY

ITEM	PART NUMBER	DESCRIPTION
8	AA56-00004-0100	CONTROL SHELF ASSY. - PLAYER #1 (NOT SEEN)
	0A56-00901-0100	DECORATIVE OVERLAY - PLAYER #1
*	A982-00017-0000	MOLDED BALL CONTROL ASSY. (2 REQ'D)
*	AA11-00015-0000	HANDLE CONTROL ASSY. (2 REQ'D)
	0017-00032-0106	PUSH BUTTON SWITCH (2 REQ'D)
	A362-00012-00XF	BOTTOM PLATE & CONTROL HINGE ASSY. (2 REQ'D)
	0362-00901-0000	LIGHT SHIELD (2 REQ'D)
	0362-00100-0000	LOCATION BRACKET (2 REQ'D)
	0017-00031-0044	WEDGE BASE LAMP SOCKET (4 REQ'D)
	0017-00003-0219	#194 WEDGE BASE LAMP (4 REQ'D)
9	A982-00014-0001	COIN DOOR & CABLE ASSY.
10	A090-00603-00XF	COIN DOOR FRAME ASSY.
11	A090-00605-0000	COIN BOX DOOR & LOCK ASSY.
	A090-00620-0000	FORMED COIN BOX & ENCLOSURE ASSY.
12	0311-00900-0000	LEG (4 REQ'D)
	0017-00101-0769	#10x3/4 SLT HEX HD. WOOD SCREW (20 REQ'D)
	0017-00102-0048	3/8-16x2" LEG LEVELERS (4 REQ'D)
	0017-00103-0026	3/8-16 LEG LEVELER HEX NUTS (4 REQ'D)
ADDITIONAL PARTS LIST		
*	AA11-00007-0000	CARD RACK W/BOARDS ASSY.
	A084-90412-D000	POWER SUPPLY - 125VA
	0624-00902-0500	P.C. SUPPORT BRKT. - 6-1/2" LG. (2 REQ'D)
	0624-00902-0100	P.C. SUPPORT BRKT. - 12" LG. (2 REQ'D)
*	A945-00020-0000	POWER CHASSIS ASSY. - 125VA, 115V
	A945-00033-0000	MAGNETIC SHIELD & LABEL ASSY.
	A945-00019-0000	LINE CORD ASSY. - 115V
	A945-00038-0000	ON - OFF SWITCH & PLATE ASSY.
	A088-00018-0000	INTERLOCK SWITCH & BRACKET ASSY.
	A775-00013-0000	FAN ASSEMBLY
	0017-00003-0430	6" x 9" SPEAKER 4 OHM, 10W (2 REQ'D)
	0017-00009-0393	BLACK SPEAKER GRILLE W/SLOTS (2 REQ'D)
	0017-00101-0127	#8-32 x 1-1/2 BLACK RND. HD. CARRIAGE BOLT (8 REQ'D)
	0017-00103-0061	#8-32 HEX NUT W/SEMS (8 REQ'D)
	0311-00102-0000	TOP SHELF MORTISE HINGE (2 REQ'D)
	0017-00101-0156	#10-32 1-1/4 BLACK RND. HD. CARRIAGE BOLT (8 REQ'D)
	0017-00103-0081	#10-32 HEX NUT W/SEMS (8 REQ'D)
	0017-00009-0534	BASSICK CLAMP (2 REQ'D)
	0610-00132-00ZN	STRIKE (2 REQ'D)
	A311-00009-0100	CLAMP & BRACKET ASSY. - R.H.
	A311-00009-0200	CLAMP & BRACKET ASSY. - L.H.
	0311-00103-00XF	CATCH (2 REQ'D)
	0017-00101-0141	#8 x 1 1/16 UNSLOT HEX HD. M.S. (22 REQ'D)

* = SEE TAPPER UPRIGHT CATALOG FOR DETAIL BREAKDOWN
OF PARTS LIST & ILLUSTRATION.

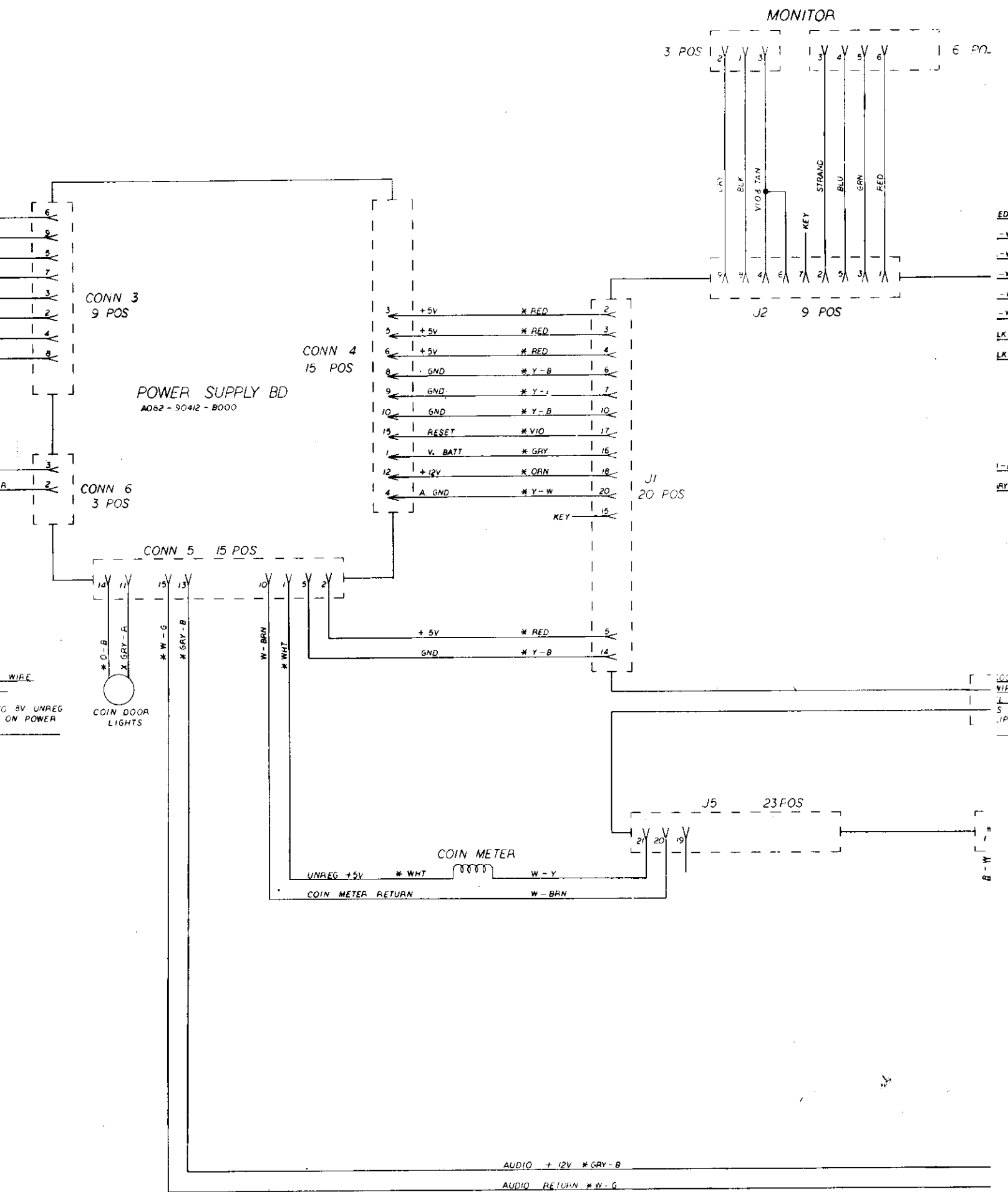

VIDEO GEN. BD.

SUPER CPU BD

A084 - 90010 - AA11

SUPER SOUND I/O BD

A084 - 90913 - AA11

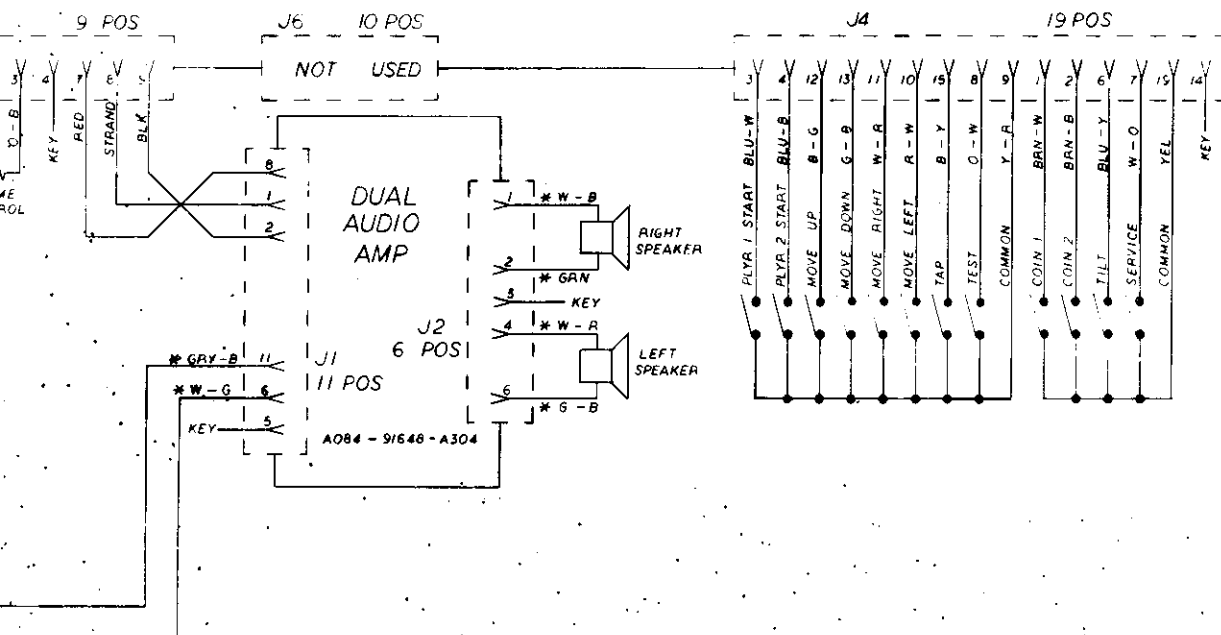

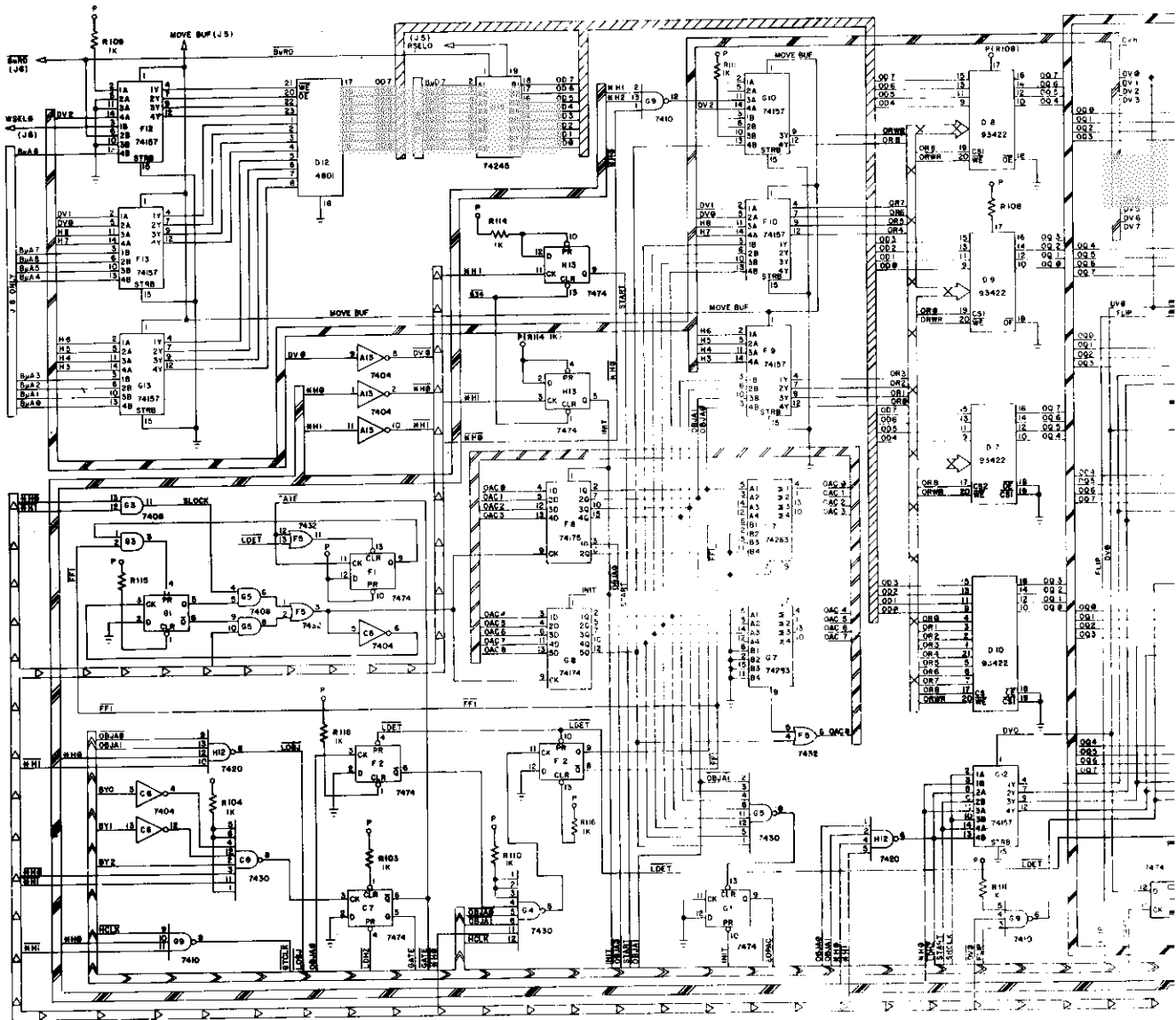

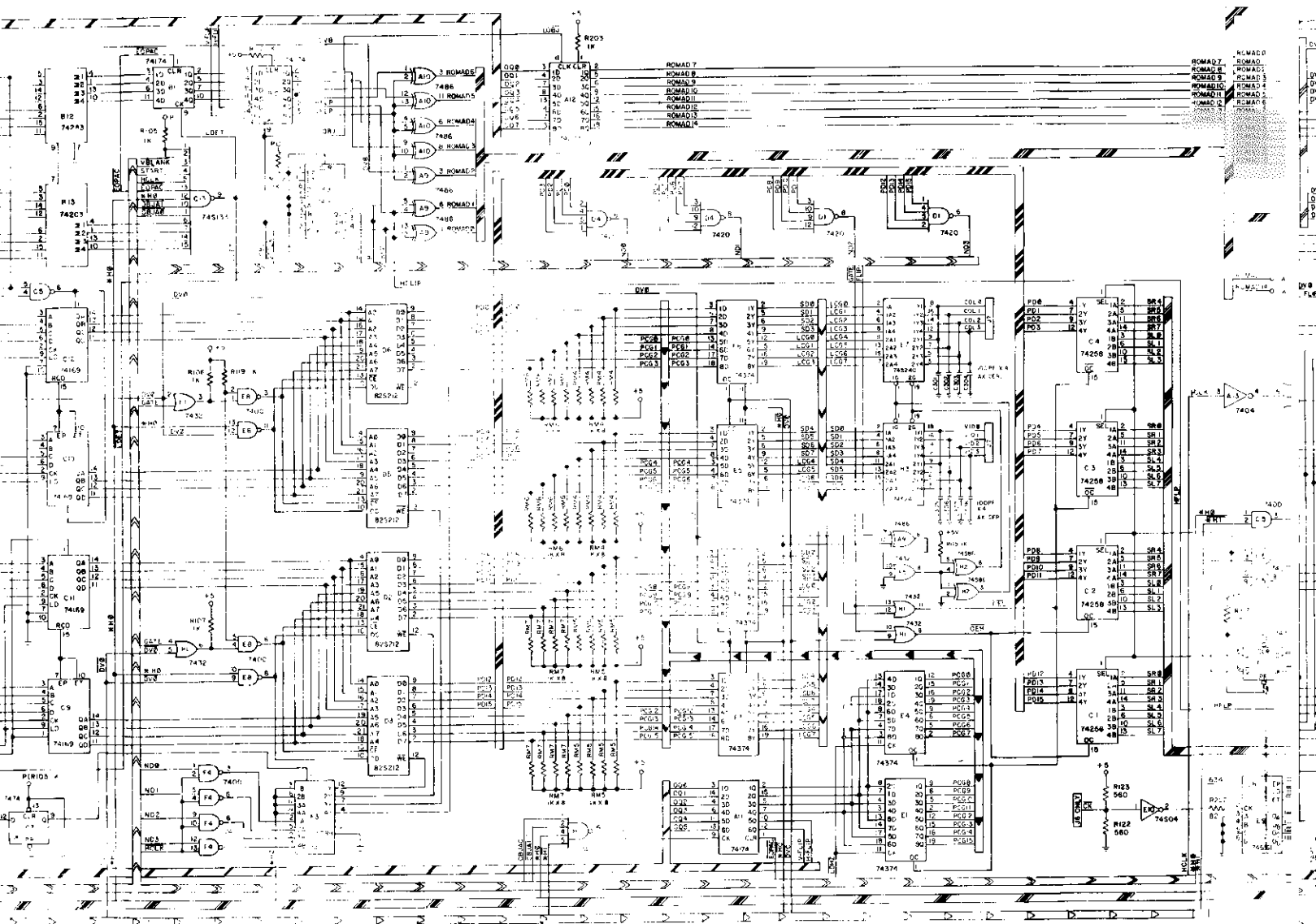

DESIGNATION LIST

<u>DESIGNATION</u>	<u>DESCRIPTION</u>	<u>DESIGNATION</u>	<u>DESCRIPTION</u>
C101	.01 MF AX CER	IC 1D	7420
C301-C308	100 PF AX CER	IC 2D	93479
CP1-CP71	.01 MF AX CER	IC 3D	93479
CP72,CP86	100 MF AX ELECT.	IC 4D	7420
CP73-CP85,CP87,	10 MF 25V AX TANT.	IC 5D	93479
CP88		IC 6D	93479
CP89,CP90,CP91	.01MF AX. CER.	IC 7D	93422
		IC 8D	93422
R101-R111,R113-	1K OHM 1/4W	IC 9D	93422
R121		IC 10D	93422
R122,R123	560 OHM 1/4W	IC 12D	STAT. RAM
R200	100 OHM 1/4W	IC 13D	74LS245
R201 R202	82 OHM 1/4W		
R203	1K OHM 1/4W	IC 1E	74LS374
RM1	82 OHM 8 PIN SIP	IC 2E	74LS374
RM 2	1K 10 PIN SIP	IC 3E	74LS374
RM 3	1K 10 PIN SIP	IC 4E	74LS374
RM 4	1K 9 PIN SIP	IC 5E	74LS374
RM 5	1K 9 PIN SIP	IC 6E	74LS374
RM 6	1K 9 PIN SIP	IC 7E	74LS240
RM 7	1K 9 PIN SIP	IC 8E	74LS00
		IC 9E	74S161
IC 1A	EPROM	IC 10E	74S04
IC 2A	EPROM	IC 1F	74LS74
IC 3A	EPROM	IC 2F	74LS74
IC 4A	EPROM	IC 3F	74LS157
IC 5A	EPROM	IC 4F	74S00
IC 6A	EPROM	IC 5F	74LS32
IC 7A	EPROM	IC 7F	74LS283
IC 8A	EPROM	IC 8F	74LS175
IC 9A	74LS86	IC 9F	74LS157
IC 10A	74LS86	IC 10F	74LS157
IC 11A	74LS174	IC 12F	74LS157
IC 12A	74LS273	IC 13F	74LS157
IC 13A	74S04	IC 1G	74LS74
		IC 3G	74S08
IC 1B	74LS194	IC 4G	74LS30
IC 2B	74LS194	IC 5G	74LS30
IC 3B	74LS194	IC 7G	74LS283
IC 4B	74LS194	IC 8G	74LS174
IC 5B	74LS194	IC 9G	74LS10
IC 6B	74LS194	IC 10G	74LS157
IC 7B	74LS194	IC 12G	74LS157
IC 8B	74LS194	IC 13G	74LS157
IC 9B	74LS161		
IC 10B	74LS174	IC 1H	74LS32
IC 11B	74LS174	IC 2H	74S86
IC 12B	74S283	IC 3H	74LS240
IC 13B	74S283	IC 11H	7420
		IC 12H	7420
IC 1C	74LS258	IC 13H	74LS74
IC 2C	74LS258		
IC 3C	74LS258	ICS1A-ICS8A	28 PIN SOCKET
IC 4C	74LS258	ICS D2,D3,D5-D10	22 PIN SOCKET
IC 5C	74LS00	ICS D12	24 PIN SOCKET
IC 6C	74LS04		
IC 7C	74LS74	J5,J6,J7	KK100 RT ANGLE
IC 8C	74LS30		24 PIN CONN.
IC 9C	74LS169		
IC 10C	74LS169	JW 1, JW2	JUMPER WIRE
IC 11C	74LS169		
IC 12C	74LS169	MCR III SUPER	A082-91464-L000
IC 13C	74S133	VIDEO GEN.	

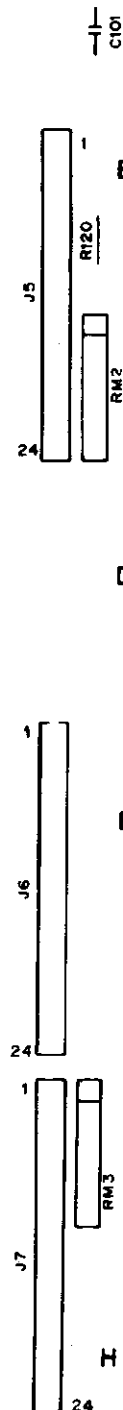

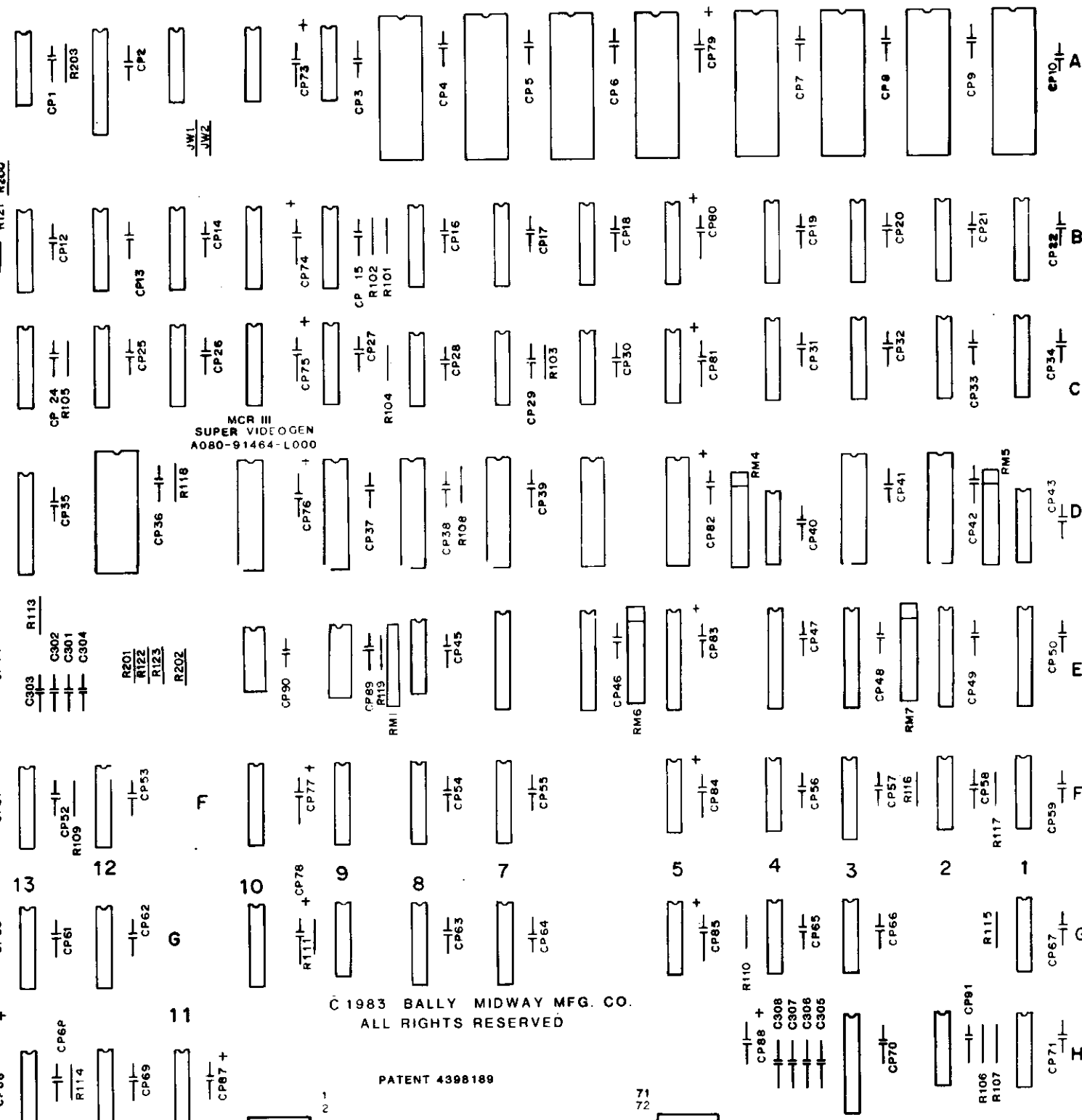

© 1983 BALLY MIDWAY MFG. CO.
ALL RIGHTS RESERVED

PATENT 4398189

CROSS REFERENCE LIST

DESCRIPTION	QTY	DESIGNATION NO.	PART NOS.
CAP 100PF	8	C301-C308	0986-00800-1000
CAP .01MF	75	C101,CP1-CP71, CP89,CP90,CP91	0986-00800-2500
CAP 10MF	15	CP73-CP85,CP87, CP88	0986-00800-2400
CAP 100MF	2	CP72,CP86	0986-00800-1800
82 OHM 1/4 W RES.	2	R201,R202	100E-00005-0031
100 OHM 1/4 W RES.	1	R200	100E-00005-0033
1K OHM 1/4 W RES.	21	R101-R111,R113- R121,R203	100E-00005-0061
560 OHM 1/4W RES.	2	R122,R123	100E-00005-0054
8 PIN SIP 82 OHM	1	RM1	102E-00004-0035
9 PIN SIP 1K OHM	4	RM4-RM7	102E-00004-0011
10 PIN SIP 1K OHM	2	RM2,RM3	102E-00004-0013
74S00	1	4F	0304-00803-0047
74LS00	2	5C,8E	0304-00803-0010
74S04	2	13A,10E	0304-00803-0011
74LS04	1	6C	0304-00803-0012
74S08	1	3G	0304-00803-0037
74LS10	1	9G	0304-00803-0014
7420	4	10,4D,11H,12H	0304-00803-0015
74LS30	3	8C,4G,5G	0304-00803-0016
74LS32	2	5F,1H	0304-00803-0017
74LS74	5	7C,1F,2F,1G,13H	0304-00803-0018
74S86	1	2H	0304-00803-0049
74LS86	2	9A,10A	0304-00803-0019
74S133	1	13C	0304-00803-0020
74LS157	8	3F,9F,10F,12F,13F, 10G,12G,13G	0304-00803-0021
74S161	1	9E	0304-00803-0038
74LS161	1	9B	0304-00803-0022
74LS169	4	9C-12C	0304-00803-0023
74LS174	4	11A,10B,11B,8G	0304-00803-0024
74LS175	1	8F	0304-00803-0025
74LS194	8	1B-8B	0304-00803-0026
74LS240	2	7E,3H	0304-00803-0050
74LS245	1	13D	0304-00803-0027
74LS258	4	1C-4C,	0304-00803-0028
74LS273	1	12A	0304-00803-0029
74S283	2	12B,13B	0304-00803-0039
74LS283	2	7F,7G	0304-00803-0030
74LS374	6	1E-6E	0304-00803-0031
93422	4	7D-10D	0304-00803-0032
93479	4	2D,3D,5D,6D	0304-00803-0033
STAT. RAM	1	12D	0304-00803-0034
EPROM KIT	8	IC1A-8A	SEE NOTE
28 PIN SOCKET	8	ICS 1A-8A	0986-00804-0300
22 PIN SOCKET	8	ICS 2D,3D,5D,6D, 7D-10D	0986-00804-0700
24 PIN SOCKET	1	ICS 12D	0986-00804-1600
KK100 RT. ANGLE	3	J5,J6,J7	0986-00804-4700
24 PIN CONN.			
JUMPER WIRE	2	JW1, JW2	0986-00805-0200
MCR III SUPER VIDEO GEN.			A082-91464-L000

NOTE: ROM PART NUMBERS
AT BACK OF CATALOG.

PROJECT ENG: R. PLOUSSARD		USED ON		REVISIONS	
DO NOT SCALE DWG.		SCALE FULL		NO. REQ'D 1 PER	
DIM TOLERANCES UNLESS SPECIFIED		HEAT TREAT		Bally / MIDWAY MFG. CO.	
DRA. 186		MATERIAL		FRANKLIN PK ILL	
CONCENTRICITY 0.001		FINISH		PART NO.	
FRACTIONAL 1/16		DATE 12/19/83		M051 - 00304 - L005	
HOLE DIA. + .002 0.00		SUPER VIDEO GEN. MCR III			
		ASSY DWG			
		A082-91464-L000			

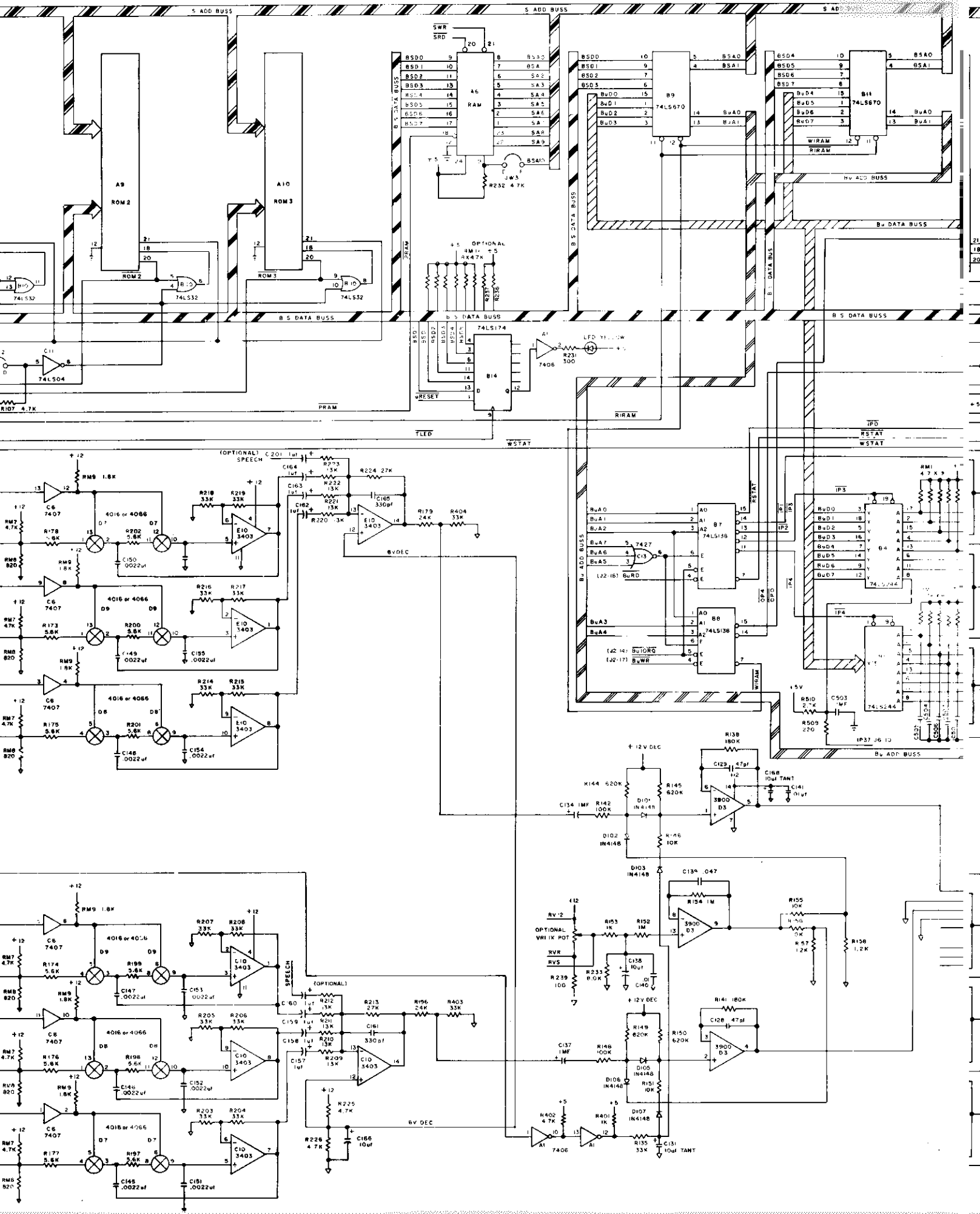

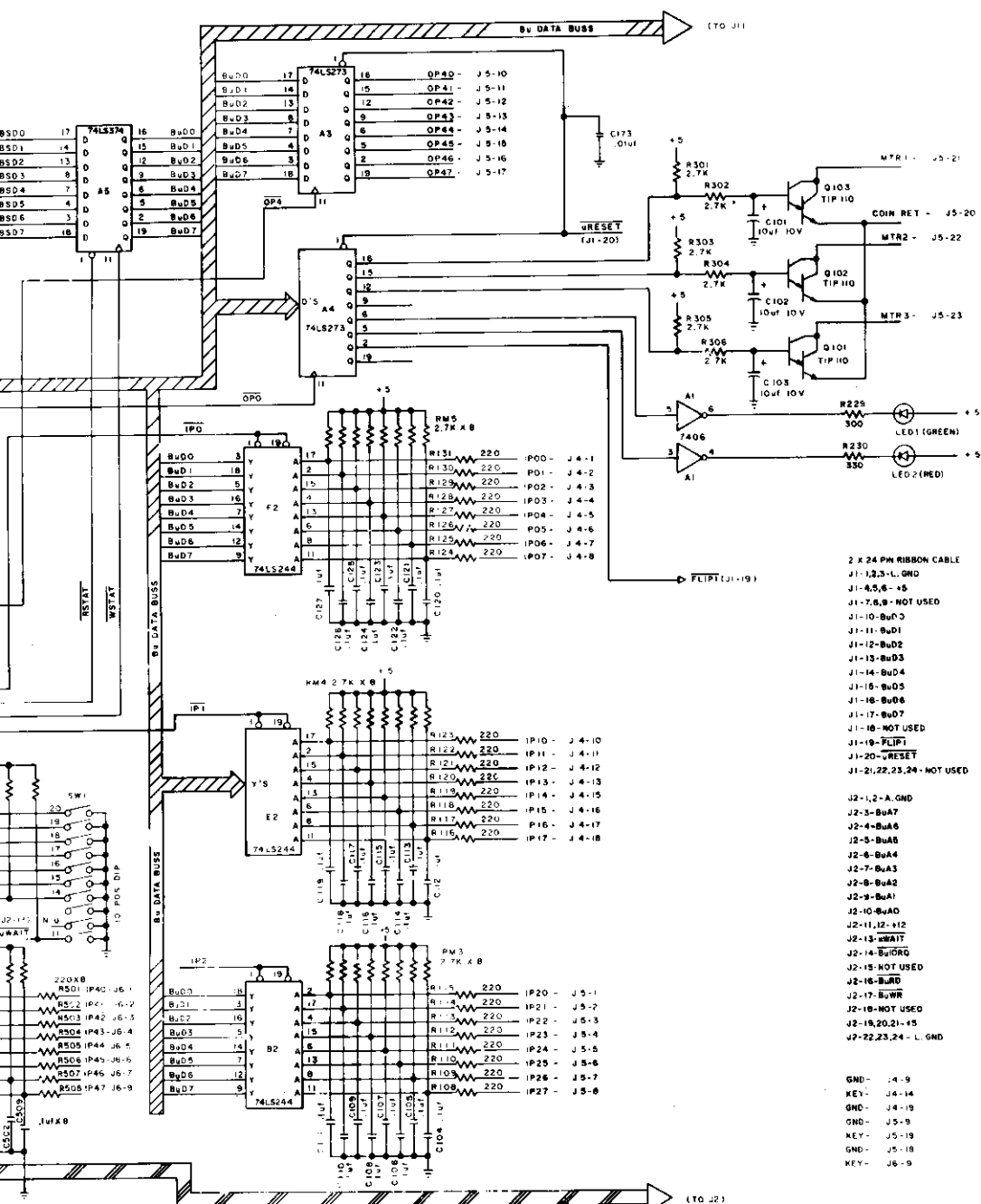

- 2 X 24 PIN RIBBON CABLE
- J1-12,3-L. GND
 - J1-4,5,6-+5
 - J1-7,8,9-NOT USED
 - J1-10-BuD2
 - J1-11-BuD1
 - J1-12-BuD2
 - J1-13-BuD3
 - J1-14-BuD4
 - J1-15-BuD5
 - J1-16-BuD6
 - J1-17-BuD7
 - J1-18-NOT USED
 - J1-19-FLIP1 (J1-19)
 - J1-20-RESET
 - J1-21,22,23,24-NOT USED
- J2-1,2-A. GND
- J2-3-BuA7
 - J2-4-BuA6
 - J2-5-BuA8
 - J2-6-BuA4
 - J2-7-BuA3
 - J2-8-BuA2
 - J2-9-BuA1
 - J2-10-BuA0
 - J2-11,12-+12
 - J2-13-+VWAT
 - J2-14-BuORG
 - J2-15-NOT USED
 - J2-16-BuRD
 - J2-17-BuWR
 - J2-18-NOT USED
 - J2-19,20,21-+5
 - J2-22,23,24-L. GND
- GND- J4-9
- KEY- J4-14
- GND- J4-19
- GND- J5-9
- KEY- J5-19
- GND- J5-18
- KEY- J6-9

- 72 PIN TEST CONN
- 1-L. GND
 - 2-+5
 - 3-L. GND
 - 4-+5
 - 5-+12
 - 6-A. GND
 - 7-+12
 - 8-NOT USED
 - 9-BuD0
 - 10-BuD1
 - 11-BuD2
 - 12-BuD3
 - 13-BuD4
 - 14-BuD5
 - 15-BuD6
 - 16-BuD7
 - 17-S00
 - 18-S01
 - 19-S02
 - 20-S03
 - 21-S04
 - 22-S05
 - 23-S06
 - 24-S07
 - 25-BuA0
 - 26-BuA1
 - 27-BuA2
 - 28-BuA3
 - 29-BuA4
 - 30-BuA5
 - 31-BuA6
 - 32-BuA7
 - 33-SAO
 - 34-SA1
 - 35-SA2
 - 36-SAS
- 37-SA4
 - 38-SA3
 - 39-SA6
 - 40-SA7
 - 41-SAB
 - 42-SAB
 - 43-SA10
 - 44-SA11
 - 45-SA12
 - 46-SA13
 - 47-SA14
 - 48-SA15
 - 49-SNMI
 - 50-SINT
 - 51-SMT
 - 52-SBUSACK
 - 53-BuRD
 - 54-BuWR
 - 55-RESET
 - 56-T8
 - 57-CLKCTL
 - 58-SND
 - 59-SWR
 - 60-SIORG
 - 61-BuORG
 - 62-SNREG
 - 63-SBUSREG
 - 64-SRSEP
 - 65-L. GND
 - 66-SWAT
 - 67-L. GND
 - 68-SKEY
 - 69-NOT USED
 - 70-+5
 - 71-L. GND
 - 72-+5

* USED ON VERSION W/PANNING
NOT USED ON VERSION W/PANNING

*4 NOT USED ON VERSION W/PANNING
USED ON VERSION W/PANNING

NOTE

ROM JUMPER OPTIONS	JW1	JW2
EPROM/ROM		
2332 COMPATIBILITY		
2732 COMPATIBILITY	K	

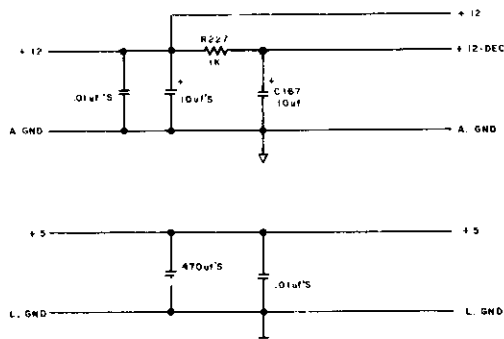

PRODUCT ENG. J. JARON		REV. 1	DATE	USED ON	NO. RECD.	PER	REVISIONS
12/16/83							
SCHEMATIC DRAWING		PART NO.		M051-00986-G016			
SUPER SOUND I/O							
A080-90915 G001							

DESIGNATION LIST

<u>DESIGNATION NO.</u>	<u>DESCRIPTION</u>	<u>DESIGNATION NO.</u>	<u>DESCRIPTION</u>	<u>DESIGNATION NO.</u>	<u>DESCRIPTION</u>
Q01-Q103	10 MF 25V AX. TANT.	R152	1MEG. OHM 1/4W 5X CRBN.	D101-D103 D105-D107	1N4148 1N4148
Q04-Q127	.1 MF 50V AX. CER.	R153	1K OHM 1/4W 5X CRBN.	Q101-Q103 Q104	T1P110 2N4403
Q28-Q129	47 PF 50V AX. CER.	R154	1MEG. OHM 1/4W 5X CRBN.	IC1A	7406
Q31	10 MF 25V AX. TANT.	R155,R156	10K OHM 1/4W 5X CRBN.	IC3A,4A	74LS273
Q134-Q137	1 MF 20V AX. TANT.	R157,R158	1.2K OHM 1/4W 5X CRBN.	IC5A	74LS374
Q138	10 MF 25V AX. TANT.	R160,R161	330 OHM 1/4W 5X CRBN.	IC6A	1K X 8 RAM
Q139	.047 MF 100V MYLAR	R162	220 OHM 1/4W 5X CRBN.	IC7A	ROM/EPROM 0
Q140	.01 MF 50V AX. CER.	R163	1.2K OHM 1/4W 5X CRBN.	IC8A	ROM/EPROM 1
Q142	100 PF 50V AX. CER.	R164	22 OHM 1/4W 5X CRBN.	IC9A	ROM/EPROM 2
Q143	.1 MF 50V AX. CER.	R165,R166	4.7K OHM 1/4W 5X CRBN.	IC10A	ROM/EPROM 3
Q144	33 PF 50V AX. CER.	R173-R178	5.6K OHM 1/4W 5X CRBN.	IC11A	74LS245
Q145-Q156	.0022 MF 100V 10X MYLAR	R179	24K OHM 1/4W 5X CRBN.	IC12A	Z-80 CPU
Q157-Q159	1 MF 20V AX. TANT.	R196	24K OHM 1/4W 5X CRBN.	IC13A	74LS08
Q160	330 PF 50V AX. CER.	R197-R202	5.6K OHM 1/4W 5X CRBN.	IC2B,4B,5B	74LS244
Q162-Q164	1 MF 20V AX. TANT.	R203-R208	33K OHM 1/4W 5X CRBN.	IC7B,8B	74LS138
Q165	330 PF 50V AX. CER.	R209-R211	13K OHM 1/4W 5X CRBN.	IC9B	74LS670
Q166-Q167	10 MF 25V AX. TANT.	R213	27K OHM 1/4W 5X CRBN.	IC10B	74LS32
Q172	10 MF 25V AX. TANT.	R214-R219	33K OHM 1/4W 5X CRBN.	IC11B	74LS670
Q173	.01 MF 50V AX. CER.	R220-R222	13K OHM 1/4W 5X CRBN.	IC12B,13B	74LS138
Q181-Q509	.1 MF 50V AX. CER.	R224	27K OHM 1/4W 5X CRBN.	IC14B	74LS174
CP1	470 MF 16V AX. ELECT.	R225,R226	4.7K OHM 1/4W 5X CRBN.	IC6C	7407
CP2-CP12	.01 MF 50V AX. CER.	R227	1K OHM 1/4W 5X CRBN.	IC10C	MC3403
CP13	470 MF 16V AX. ELECT.	R228	4.7K OHM 1/4W 5X CRBN.	IC11C	74LS04
CP14-CP19	.01 MF 50V AX. CER.	R231	300 OHM 1/4W 5X CRBN.	IC12C	74LS04
CP20	10 MF 25V AX. TANT.	R232	4.7K OHM 1/4W 5X CRBN.	IC13C	MC14024
CP21-CP27	.01 MF 50V AX. CER.	R233	3K OHM 1/4W 5X CRBN.	IC14C	7427
CP29-CP33	.01 MF 50V AX. CER.	R234,R235	4.7K OHM 1/4W 5X CRBN.	IC3D	74LS367
CP34	10 MF 25V AX. TANT.	R239	100 OHM 1/4W 5X CRBN.	IC6D	LM3900
CP35-CP46	.01 MF 50V AX. CER.	R301-R306	2.7K OHM 1/4W 5X CRBN.	IC7D-9D	74LS02
CP47	470 MF 16V AX. ELECT.	R401	1K OHM 1/4W 5X CRBN.	IC11D	MC14016
CP48-CP51	.01 MF 50V AX. CER.	R402	4.7K OHM 1/4W 5X CRBN.	IC12D	74190
CP52,CP53	10 MF 25V AX. TANT.	R403,R404	33K OHM 1/4W 5X CRBN.	IC13D	PROMSB2A
CP54	470 MF 16V AX. ELECT.	R405-R407	4.7K OHM 1/4W 5X CRBN.	IC2E	74166
CP202-CP204	10 MF 25V AX. TANT.	R501-R509	220 OHM 1/4W 5X CRBN.	IC10E	74LS244
R101-R107	4.7K OHM 1/4W 5X CRBN.	R510	2.7K OHM 1/4W 5X CRBN.	IC11E	MC3403
R108-R131	220 OHM 1/4W 5X CRBN.	RM1	4.7K OHM 10 PIN S.I.P.	IC12E	74161
R133	33K OHM 1/4W 5X CRBN.	RM2-RM5	2.7K OHM 10 PIN S.I.P.	IC2F	74126
R138,R141	180K OHM 1/4W 5X CRBN.	RM7	4.7K OHM 8 PIN S.I.P.	IC3F-5F	74LS244
R142	100K OHM 1/4W 5X CRBN.	RM8	820 OHM 8 PIN S.I.P.	IC6F,7F	74LS191
R144,R145	620K OHM 1/4W 5X CRBN.	RM9	1.8K OHM 10 PIN S.I.P.	IC8F-10F	74LS191
R146	10K OHM 1/4W 5X CRBN.	RM14	4.7K OHM 10 PIN S.I.P.	IC11F	7474
R148	100K OHM 1/4W 5X CRBN.			IC12F	74S04
R149,R150	620K OHM 1/4W 5X CRBN.			ICS6A-ICS10A	24 PIN IC SOCKET
R151	10K OHM 1/4W 5X CRBN.			ICS12A	40 PIN IC SOCKET
				ICS12D	16 PIN IC SOCKET
				ICS6F,7F	40 PIN IC SOCKET
				J1,J2	24 PIN KK100 RT. ANGLE
				J3	9 PIN KK100 RT. ANGLE OMIT 4
				J4	19 PIN KK100 RT. ANGLE OMIT 14
				J5	23 PIN KK100 RT. ANGLE OMIT 19
				J6	10 PIN KK100 RT. ANGLE OMIT 8
				JW1,JW2	JUMPER WIRE
				LED 3	YELLOW LED
				SW1	10 POSITION DIP
				SW3	8 POSITION DIP
				SW4	PUSHBUTTON S.W.
				XTAL 1	16 MHZ XTAL
				MHQ101-MHQ103	SNAP
				A080-90913-6000	SUPER SND. I/O BD.

DESCRIPTION

33 PF 50V 5% AX.
CER.
47 PF 50V AX.
CER.
100 PF 50V 5% AX.
CER.
330 PF 50V AX.
CER.
.0022 MF 100V 10%
MYLAR
.047 MF 100V
MYLAR
.01 MF 50V AX.
CER.

.1 MF 50V AX. CER.
1 MF 20V AX. TANT.
10 MF 25V AX.
TANT.

470 MF 16V AX.
ELECT.

22 OHM 1/4W 5%
CRBN.
100 OHM 1/4W 5%
CRBN.
220 OHM 1/4W 5%
CRBN.
300 OHM 1/4W 5%
CRBN.
330 OHM 1/4W 5%
CRBN.
1K OHM 1/4W 5%
CRBN.
1.2K OHM 1/4W 5%
CRBN.
2.7K OHM 1/4W 5%
CRBN.
3K OHM 1/4W 5%
CRBN.
4.7K OHM 1/4W 5%
CRBN.

5.6K OHM 1/4W 5%
CRBN.
10K OHM 1/4W 5%
CRBN.
13K OHM 1/4W 5%
CRBN.
24K OHM 1/4W 5%
CRBN.
27K OHM 1/4W 5%
CRBN.
33K OHM 1/4W 5%
CRBN.

100K OHM 1/4W 5%
CRBN.
180K OHM 1/4W 5%
CRBN.
620K OHM 1/4W 5%
CRBN.
1 MEG. OHM 1/4W
5% CRBN.

820 OHM 8 PIN
S.I.P.
1.8K OHM 10 PIN
S.I.P.
2.7K OHM 10 PIN
S.I.P.
4.7K OHM 8 PIN
S.I.P.
4.7K OHM 10 PIN
S.I.P.

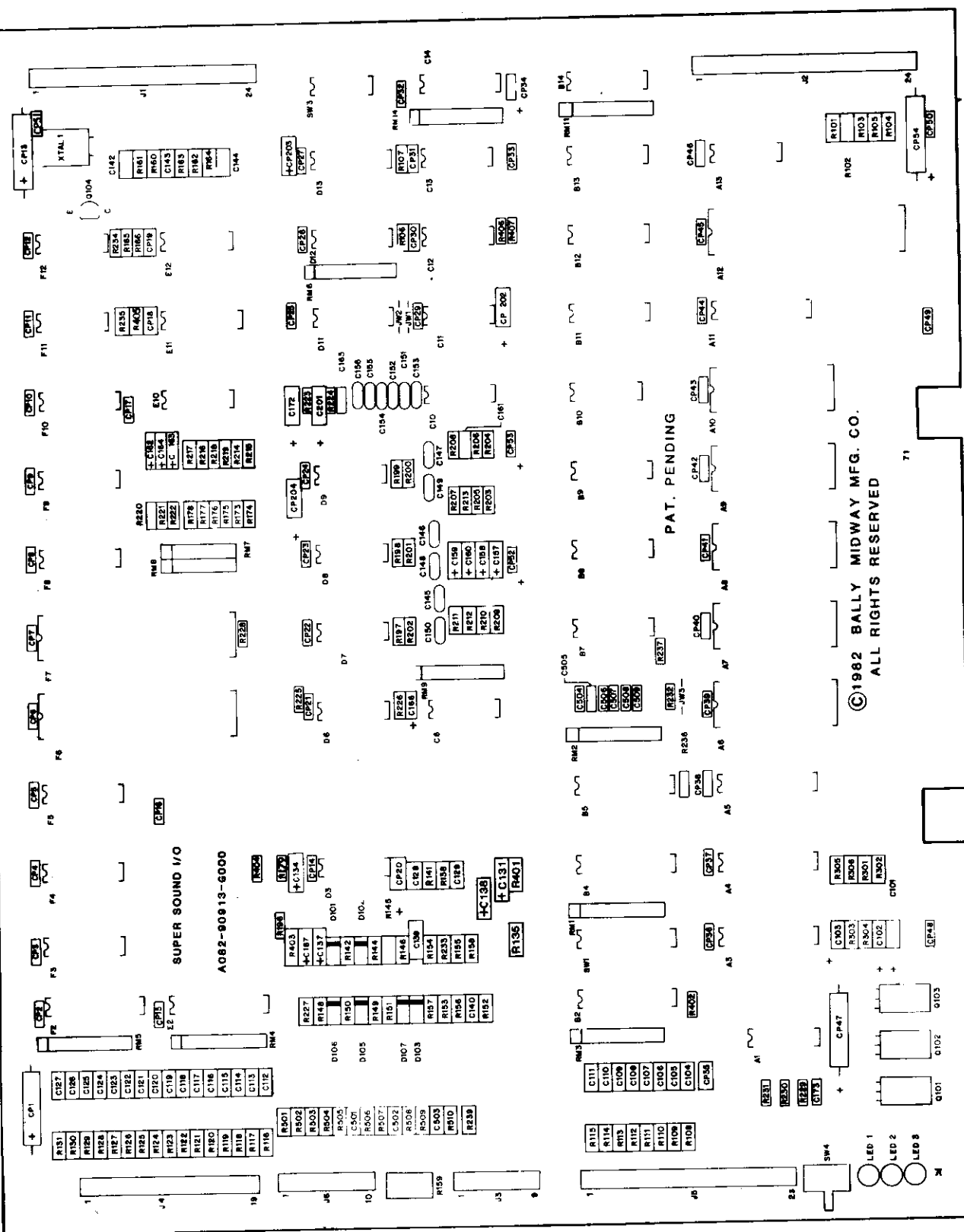

CROSS REFERENCE LIST

QTY	DESIGNATION NO.	PART NOS.	DESCRIPTION	QTY	DESIGNATION NO.	PART NOS.
1	C144	0986-00800-0300	1N4148	6	D101-D103,D105-D107	0986-00801-0200
2	C128,C129	0986-00800-2800	2N4403	1	Q104	0986-00802-0500
1	C142	0986-00800-1000	T1P110	3	Q101-Q103	0986-00802-0400
2	C161,C165	0986-00800-1300	74LS02	1	IC 6D	0986-00803-7400
12	C145-C156	0986-00800-1200	74LS04	1	IC 11C	0986-00803-6900
1	C139	0986-00800-2600	7406	1	IC 12F	0986-00803-6600
			7407	1	IC 1A	0986-00803-7600
				1	IC 6C	0986-00803-5900
47	CP2-CP12,CP14-CP19,CP21-CP27,CP29-CP33,CP35-CP46,CP48-CP51,C140,C173	0986-00800-2000	74LS08	1	IC 13A	0986-00803-7300
			7427	1	IC 13C	0986-00803-7200
			74LS32	1	IC 10B	0986-00803-6100
			7474	1	IC 11F	0986-00803-6700
			74126	1	IC 12E	0986-00803-6800
34	C104-C127,C143,C501-C509	0986-00800-1100	74LS138	4	IC78,8B,12B,13B	0986-00803-6500
8	C134,C137,C157-C159,C162-C164	0986-00800-1400	74161	1	IC 11E	0986-00803-5100
			74166	1	IC 13D	0986-00803-5300
15	CP20,CP34,CP52,CP53,CP202-CP204,C101-C103,C131,C138,C166,C167,C172	0986-00800-0700	74LS174	1	IC 14B	0986-00803-7500
			74190	1	IC 11D	0986-00803-9400
			74LS191	6	IC3F-5F,8F-10F	0986-00803-5600
4	CP1,CP13,CP47,CP54	0986-00800-2700	74LS244	5	IC2B,4B,5B,2E,2F	0986-00803-4800
			74LS245	1	IC 11A	0986-00803-6400
1	R164	0062-063B3-1XXX	74LS273	2	IC3A,4A	0986-00803-4700
			74LS367	1	IC 14C	0986-00803-7000
1	R239	0062-110B3-1XXX	74LS374	1	IC 5A	0986-00803-4600
			74LS670	2	IC9B,11B	0986-00803-6300
34	R108-R131,R162,R501-R509	0062-133B3-1XXX	AY-3-8910	2	IC6F,7F	0986-00803-8500
			LM3900	1	IC 3D	0986-00803-4900
1	R231	0062-141B3-1XXX	MC3403	2	IC10C,10E	0986-00803-5000
			MC14016	3	IC7D-9D	0986-00803-6200
2	R160,R161	0062-144B3-1XXX	MC14024	1	IC 12C	0986-00803-7100
			PROMSB2-A	1	IC 12D	0986-00803-8200
3	R153,R227,R401	0062-179B3-1XXX	RAM 1K X 8	1	IC 6A	0986-00803-8000
			ROM/EPROM 0	1	IC 7A	
3	R157,R158,R163	0062-183B3-1XXX	ROM/EPROM 1	1	IC 8A	
			ROM/EPROM 2	1	IC 9A	
7	R301-R306,R510	0062-199B3-1XXX	ROM/EPROM 3	1	IC 10A	
			Z-80(3880)	1	IC 12A	0986-00803-5500
1	R233	0062-201B3-1XXX	16 PIN IC SOCKET	1	ICS 12D	0986-00804-1400
19	R101-R107,R165,R166,R225,R226,R228,R232,R234,R235,R402,R405-R407	0062-211B3-1XXX	24 PIN IC SOCKET	5	ICS6A-ICS10A	0986-00804-1600
			40 PIN IC SOCKET	3	ICS12A,ICS6F,ICS7F	0986-00804-1500
12	R173-R178,R197-R202	0062-215B3-1XXX	9 PIN KK 100 RT. ANGLE OMIT 4	1	J3	3000-16366-0901
4	R146,R151,R155,R156	0062-227B3-1XXX	10 PIN KK 100 RT. ANGLE OMIT 8	1	J6	3000-16366-1001
6	R209-R211,R220-R222	0062-233B3-1XXX	19 PIN KK 100 RT. ANGLE OMIT 14	1	J4	3000-16366-1901
2	R179,R196	0062-245B3-1XXX	23 PIN KK 100 RT. ANGLE OMIT 19	1	J5	3000-16366-2301
			24 PIN KK 100 RT. ANGLE	2	J1,J2	0986-00804-4700
2	R213,R224	0062-247B3-1XXX				
15	R135,R203-R208,R214-R219,R403,R404	0062-251B3-1XXX	JUMPER WIRE	2	JW1,JW2	0986-00804-4000
2	R142,R148	0062-275B3-1XXX	YELLOW LED	1	LED 3	0986-00804-2000
2	R138,R141	0062-287B3-1XXX	8 POSITION DIP SW.	1	SW3	0986-00805-0900
			10 POSITION DIP SW.	1	SW1	0986-00805-1000
4	R144,R145,R149,R150	0062-313B3-1XXX	PB SWITCH	1	SW4	0986-00804-1700
2	R152,R154	0062-323B3-1XXX	16 MHZ XTAL W/3RD LEAD	1	XTAL 1	0986-00805-1100
1	RM8	0986-00805-0800	SNAPS	3	MHQ101-MHQ103	0017-00007-0134
1	RM9	0986-00805-0600	SUPER SMD. I/O 80.	1		A080-90913-6000
4	RM2-RM5	0986-00805-0500				
1	RM7	0986-00805-0400				
2	RM1,RM14	0986-00805-0300				

NOTE: ROM PART NUMBERS
AT BACK OF CATALOG.

PROJECT ENG: C. MEDNICK		USED ON		REVISIONS	
DO NOT SCALE DWG		SCALE FULL		NO. REQ'D 1 PER	
DIM TOLERANCES UNLESS SPECIFIED		SUPER SOUND MO BD. ASSEMBLY DWG		PART NO. M051 - 00986 - G015	
DATE 12/19/83		A082-90913-6000			

FRANKLIN PK ILL

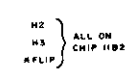

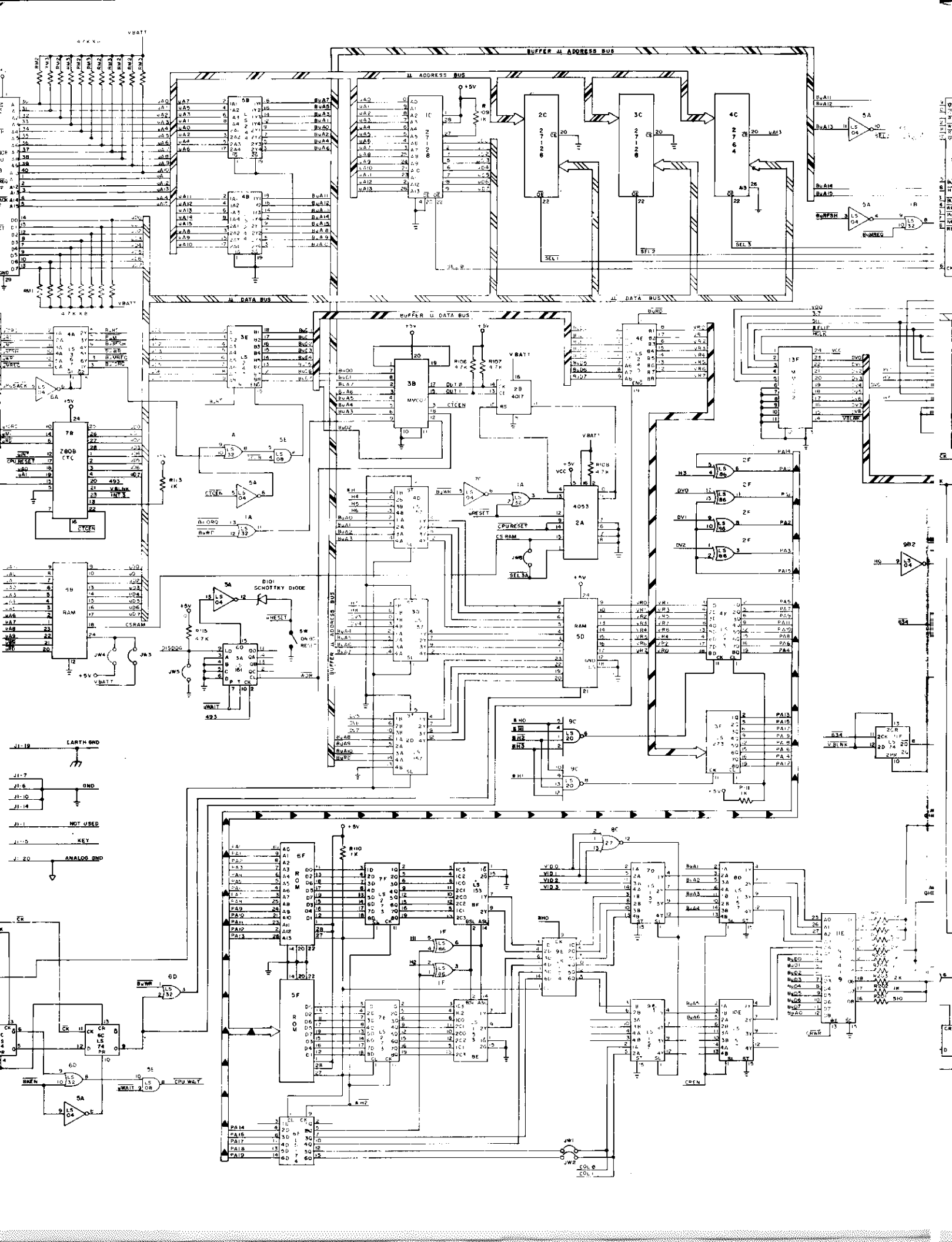

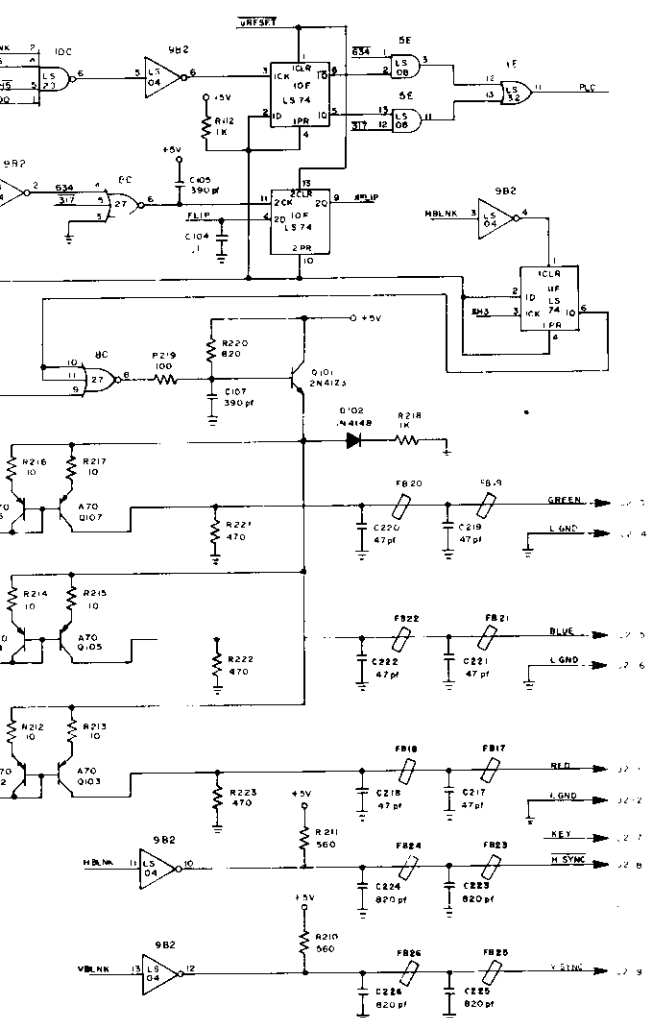
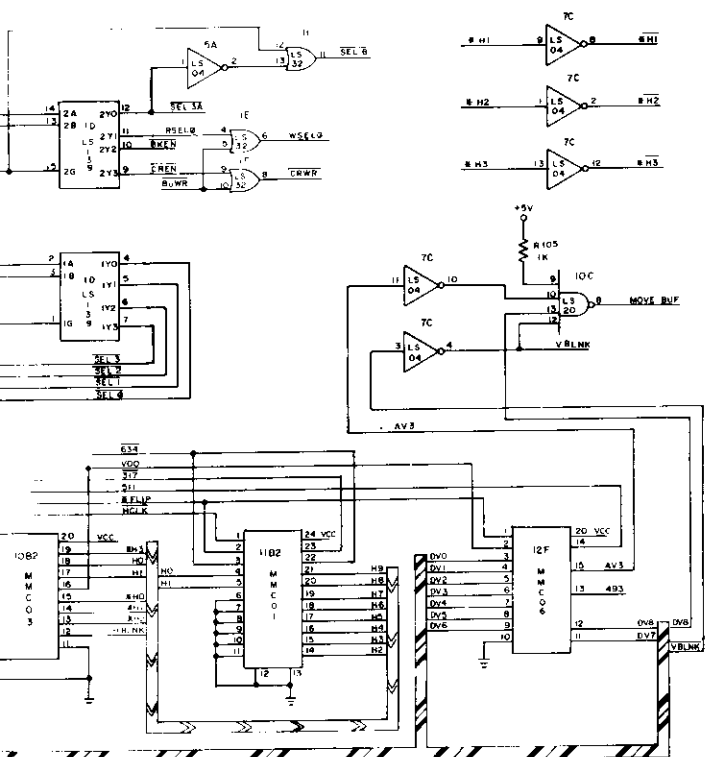

PROJECT		REVISED		DATE	
R. WYAND		FULL		12/16/83	
5MHz CPU		NO REVISIONS		MIDWAY MFG. CO.	
SCHEMATIC DWG		A000-91490-M000		PART NO.	
				M051-00304-M010	

DESIGNATION LIST

<u>DESIGNATION NO.</u>	<u>DESCRIPTION</u>	<u>DESIGNATION NO.</u>	<u>DESCRIPTION</u>
CP1-CP42	.01 MF AX. CER.	IC 4A	74LS367
CP43-CP65	10 MF 25V AX.	IC 5A	74LS04
	TANT.	IC 6A	74SD4
CP66-CP69	470 MF 16V AX.		
	ELECT.	IC 1B	74LS32
CP70	.01 MF AX. CER.	IC 2B	4017
C101	33 PF AX. CER.	IC 3B	MMC07
C102	47 PF AX. CER.	IC 4B, IC 5B	74LS244
C103	.1 UF AX. CER.	IC 6B	NV RAM
C104	.1 UF AX. CER.	IC 7B	Z80B CTC
C105	390 PF AX. CER.	IC 8B	Z80B
C107	390 PF AX. CER.	IC 9B1	74S161
C201-C216	390 PF AX. CER.	IC 9B2	74LS04
C217-C222	47 PF AX. CER.	IC 10B1	74LS08
C223-C226	820 PF AX. CER.	IC 10B2	MMC03
		IC 11B1	74LS86
R101	82K OHM 1/4W 5%	IC 11B2	MMC01
	CRBN.	IC 1C, IC 2C,	EPROM
R102	39 OHM 1/4W 5%	IC 3C, IC 4C	
	CRBN.	IC 5C, IC 6C	74LS74
R104, R105	1K OHM 1/4W 5%	IC 7C	74LS04
	CRBN.	IC 8C	7427
R106-R108	4.7K OHM 1/4W 5%	IC 9C, IC 10C	74LS20
	CRBN.		
R109-R114	1K OHM 1/4W 5%	IC 1D	74LS139
	CRBN.	IC 2D, IC 3D,	74LS157
R115	4.7K OHM 1/4W 5%	IC 4D, IC 7D	
	CRBN.	IC 8D	
R201	510 OHM 1/4W 5%	IC 5D	RAM
	CRBN.	IC 6D	74LS32
R202	1K OHM 1/4W 5%		
	CRBN.	IC 1E	74LS32
R203	2K OHM 1/4W 5%	IC 3E, IC 4E	74LS245
	CRBN.	IC 5E	74LS08
R204	510 OHM 1/4W 5%	IC 6E, IC 9E	74LS174
	CRBN.	IC 7E	74LS273
R205	1K OHM 1/4W 5%	IC 8E	74LS153
	CRBN.	IC 10E	74LS157
R206	2K OHM 1/4W 5%	IC 11E	93419
	CRBN.		
R207	510 OHM 1/4W 5%	IC 1F, IC 2F	74LS86
	CRBN.	IC 3F, IC 4F,	74LS273
R208	1K OHM 1/4W 5%	IC 7F	
	CRBN.	IC 5F, IC 6F	EPROM
R209	2K OHM 1/4W 5%	IC 8F	74LS153
	CRBN.	IC 9F	74LS157
R210, R211	560 OHM 1/4W 5%	IC 10F, IC 11F	74LS74
	CRBN.	IC 12F	MMC06
R212-R217	10 OHM 1/4W 5%	IC 13F	MMC02
	CRBN.		
R218	1K OHM 1/4W 5%	FB1-FB2B	FERRITE BEAD
	CRBN.		
R219	100 OHM 1/4W 5%	ICS 13FA,	8 PIN DIP SOCKET
	CRBN.	ICS 11B2A	
R220	820 OHM 1/4W 5%	ICS 13FB,	16 PIN DIP SOCKET
	CRBN.	ICS 11B2B	
R221-R223	470 OHM 1/4W 5%	ICS 3B, ICS 10B2,	20 PIN DIP SOCKET
	CRBN.	ICS 12F	
R301	82 OHM 1/4W 5% CRBN	ICS 6B, 5D	24 PIN DIP SOCKET
R302, R303	68 OHM 1/4W 5% CRBN	ICS 7B, ICS 1C-4C,	28 PIN DIP SOCKET
		ICS 11E, ICS 5F,	
RM1	4.7K OHM 9 PIN	ICS 6F	
	SIP	ICS 8B	40 PIN DIP SOCKET
RM2, RM3	4.7K OHM 8 PIN		
	SIP	J1	20 PIN .156C
RM4	4.7K OHM 6 PIN	J2	CONN. OMIT 15
	SIP	J3-J7	9 PIN .100C
D101	1N5817		CONN. OMIT 3
D102	1N4148		HEADER
Q101	2N4123		
Q102-Q107	A 70		FLEX PACK JUMPERS
Q108	2N4403	JW1-JW6	JUMPERS
OSC 1	20 MHZ + 0.1%	SW1	PUSH BUTTON SW.
	OSCILLATOR	A080-91490-W000	5 MHZ CPU BD.
IC 1A	74LS32		
IC 2A	4053		
IC 3A	74LS161		

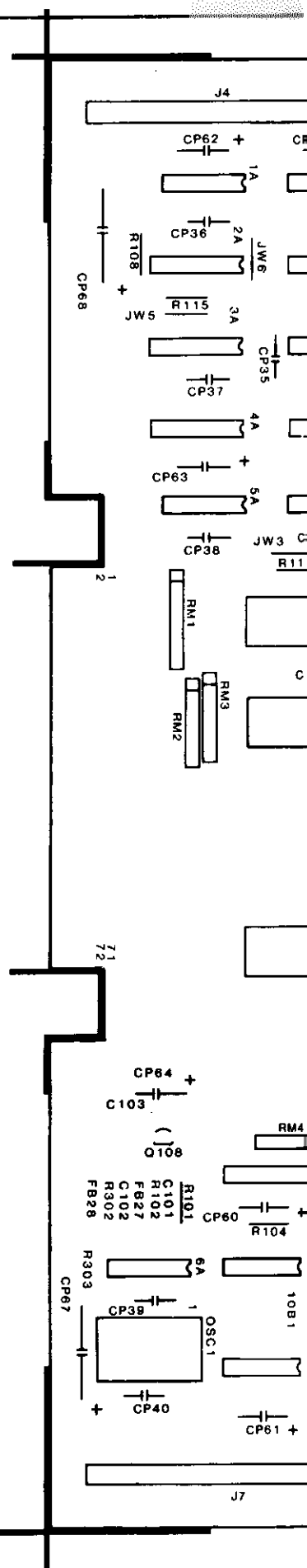

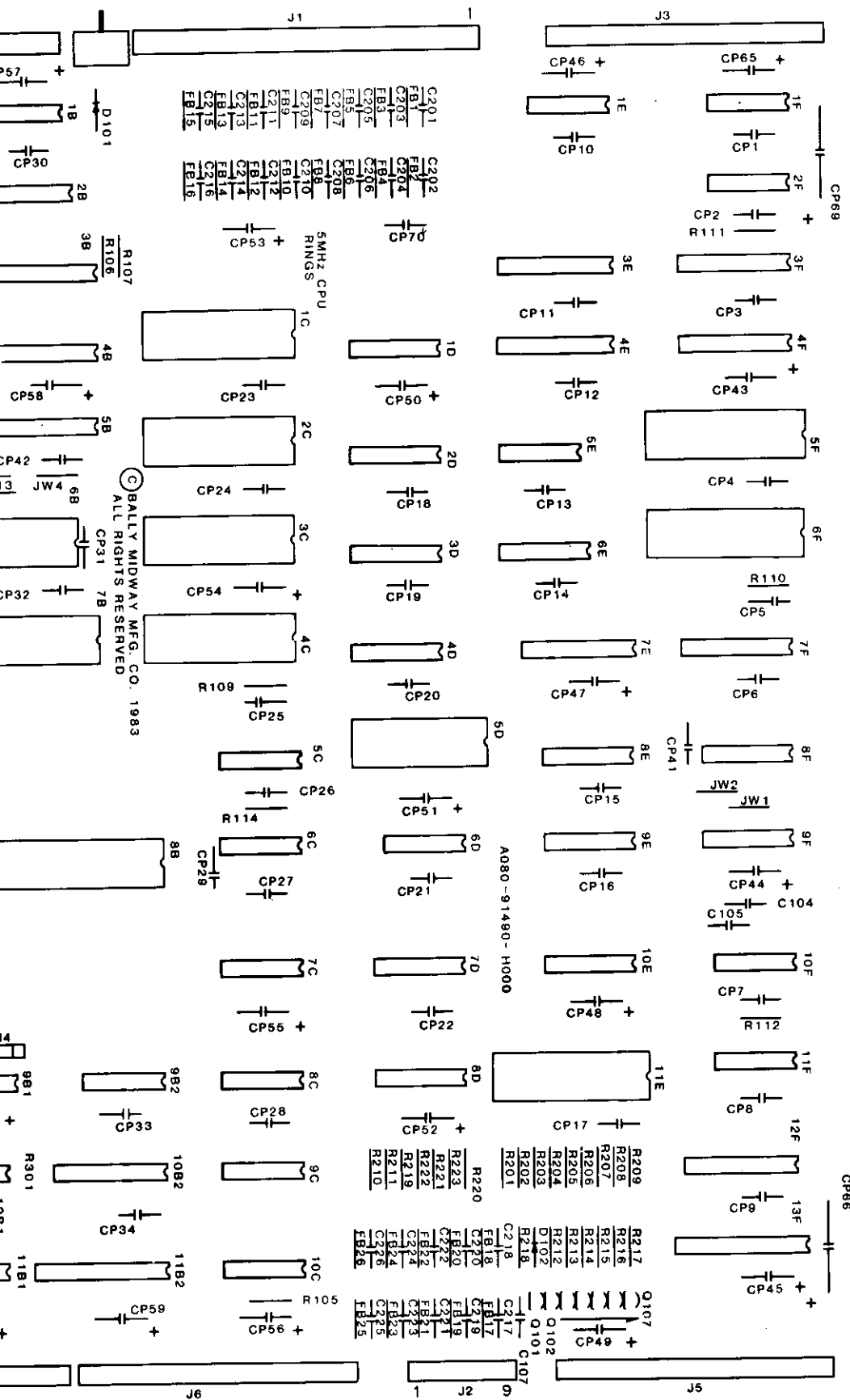

DESCRIPTION	QTY	DESIG
33 PF 50V AX. CER.	1	C101
47 PF 50V AX. CER.	7	C102, C
390 PF 50V AX. CER.	18	C105, C216
820 PF 50V AX. CER.	4	C223-
.01 MF 50V 20% AX. CER.	43	CP1-C
.1 MF 50V 20% AX. CER.	2	C103,
10 MF 25V 10% AX. TANT.	23	CP43-
470 MF 16V AX. ELECT.	4	CP66-
10 OHM 1/4W 5% CRBN.	6	R212-
39 OHM 1/4W 5% CRBN	1	R102
68 OHM 1/4W 5% CRBN	2	R302,
82 OHM 1/4W 5% CRBN	1	R301
100 OHM 1/4W 5% CRBN.	1	R219
470 OHM 1/4W 5% CRBN.	3	R221-
510 OHM 1/4W 5% CRBN.	3	R201,
560 OHM 1/4W 5% CRBN.	2	R210,
820 OHM 1/4W 5% CRBN.	1	R220
1K OHM 1/4W 5% CRBN.	12	R104,
2K OHM 1/4W 5% CRBN.	3	R114,
4.7K OHM 1/4W 5% CRBN.	4	R208,
82K OHM 1/4W 5% CRBN.	1	R203,
4.7K OHM 9 PIN SIP.	1	R106-
4.7K OHM 8 PIN SIP.	2	R101
4.7K OHM 6 PIN SIP.	1	RM1
1N5817	1	RM2, F
1N4148	1	RM4
2N4123	1	D101
A 70	6	D102
2N4403	1	Q101
20 MHZ + 0.1% OSCILLATOR	1	Q102-
4017	1	Q108
4053	1	OSC1
74LS04	3	IC 2E
74LS08	2	IC 2A
74LS20	2	IC 9E
7427	1	IC 1C
		IC 9B
		IC 8C

CROSS REFERENCE LIST

DESIGNATION NO.	PART NOS.	DESCRIPTION	QTY	DESIGNATION NO.	PART NOS.
1	0986-00800-0300	74LS32	4	IC 1A,1B,6D,1E	0986-00803-0600
2,C217-C222	0986-00800-2800	74LS74	4	IC 5C,6C,10F,11F	0986-00803-1005
5,C107,C201-	0986-00800-3000	74LS86	3	IC 11B1,1F,2F	0986-00803-9900
3-C226	0945-00816-0400	74LS139	1	IC 1D	0304-00803-0042
		74LS153	2	IC 8E,8F	0986-00803-1000
		74LS157	7	IC 2D,3D,4D,7D,8D	0986-00803-9700
				10E,9F	
CP42,CP70	0986-00800-2200	74LS161	1	IC 3A	0986-00803-1003
3,C104	0986-00800-0200	74LS174	2	IC 6E,9E	0986-00803-9800
CP65	0986-00800-3400	74LS244	2	IC 4B,5B	0986-00803-0800
CP69	0986-00800-3300	74LS245	2	IC 3E,4E	0986-00803-0900
		74LS273	4	IC 7E,3F,4F,7F	0986-00803-1001
		74LS367	1	IC 4A	0986-00803-2200
		74S04	1	IC 6A	0986-00803-0400
		74S161	1	IC 9B1	0304-00803-0038
		93419	1	IC 11E	0986-00803-9600
		EPROM	6	IC 1C,2C,3C,4C,	SEE NOTE
				5F,6F	
R217	100E-00005-0011	MMC01	1	IC 11B2	0986-00803-8900
	100E-00005-0023	MMC02	1	IC 13F	0986-00803-9000
2,R303	100E-00005-0029	MMC03	1	IC 10B2	0986-00803-9100
	100E-00005-0031	MMC07	1	IC 3B	0986-00804-3200
	100E-00005-0033	NV RAM	1	IC 6B	0986-00803-8100
		RAM	1	IC 5D	0986-00803-1008
		Z80B	1	IC 8B	0304-00803-0041
R223	100E-00005-0051	Z80B CTC	1	IC 7B	0304-00803-0040
		MMC06	1	IC 12F	0304-00803-9200
R204,R207	100E-00005-0053	FERRITE BEAD	28	FB1-FB28	0316-00804-0002
R211	100E-00005-0054	8 PIN DIP SOCKET	2	ICS 13FA,	0986-00804-3600
				ICS 11B2A	
	100E-00005-0058	16 PIN DIP SOCKET	2	ICS 13FB,	0986-00804-3700
				ICS 11B2B	
R105,R109-	100E-00005-0061	20 PIN DIP SOCKET	3	ICS 3B,ICS 10B2,	0986-00804-3800
R202,R205,				ICS 12F	
R218		24 PIN DIP SOCKET	2	ICS 6B,ICS 5D	0986-00804-3400
R206,R209	100E-00005-0068	28 PIN DIP SOCKET	8	ICS 7B,ICS 1C-4C,	0986-00804-3900
				ICS 11E,ICS 5F,	
R108,R115	100E-00005-0079	40 PIN DIP SOCKET	1	ICS 6F	0986-00804-3500
	100E-00005-0112			ICS 8B	
		FMD. HDR. .100C	1	J2	3000-16366-0902
		OMIT 3			
	102E-00004-0024	FMD. HDR. .156C	1	J1	3000-16387-2010
		OMIT 15			
RM3	102E-00004-0025	HEADER	5	J3-J7	0986-00804-4700
	102E-00004-0027	FLEX PACK JUMPERS	5	-	0986-00804-4800
		JUMPERS	6	JW1-JW6	0986-00804-4000
	103E-00003-0009	PUSH BUTTON SW.	1	SW1	0986-00804-3100
	103E-00002-0005				
	104E-00001-0007	5 MHZ CPU BD.	1		A080-91490-H000
	104E-00002-0012				
	104E-00002-0006				
	0304-00804-0007				
	0986-00803-8700				
	0986-00803-2000				
2,7C,5A	0986-00803-1007				
B1,5E	0986-00803-1006				
10C	0986-00803-1004				
	0304-00803-0046				

NOTE : ROM PARTS NUMBERS
AT BACK OF CATALOG.

PROJECT ENG: R. PLOUSSARD		USED ON		REVISIONS	
DO NOT SCALE DWS		HEAT TREAT	SCALE FULL	NO. REQ'D PER	
DIM TOLERANCES UNLESS SPECIFIED		MAX'L.	ASSEMBLY DRAWING		PART NO.
UNCONCENTRICITY T-H .001		FINISH	5 MHZ CPU		M051 - 00304 - H009
FRACTIONAL .156		A082-91490-H000			
DECIMAL .001					
HOLE DIA + .002 .000					
DATE 12/19/83					

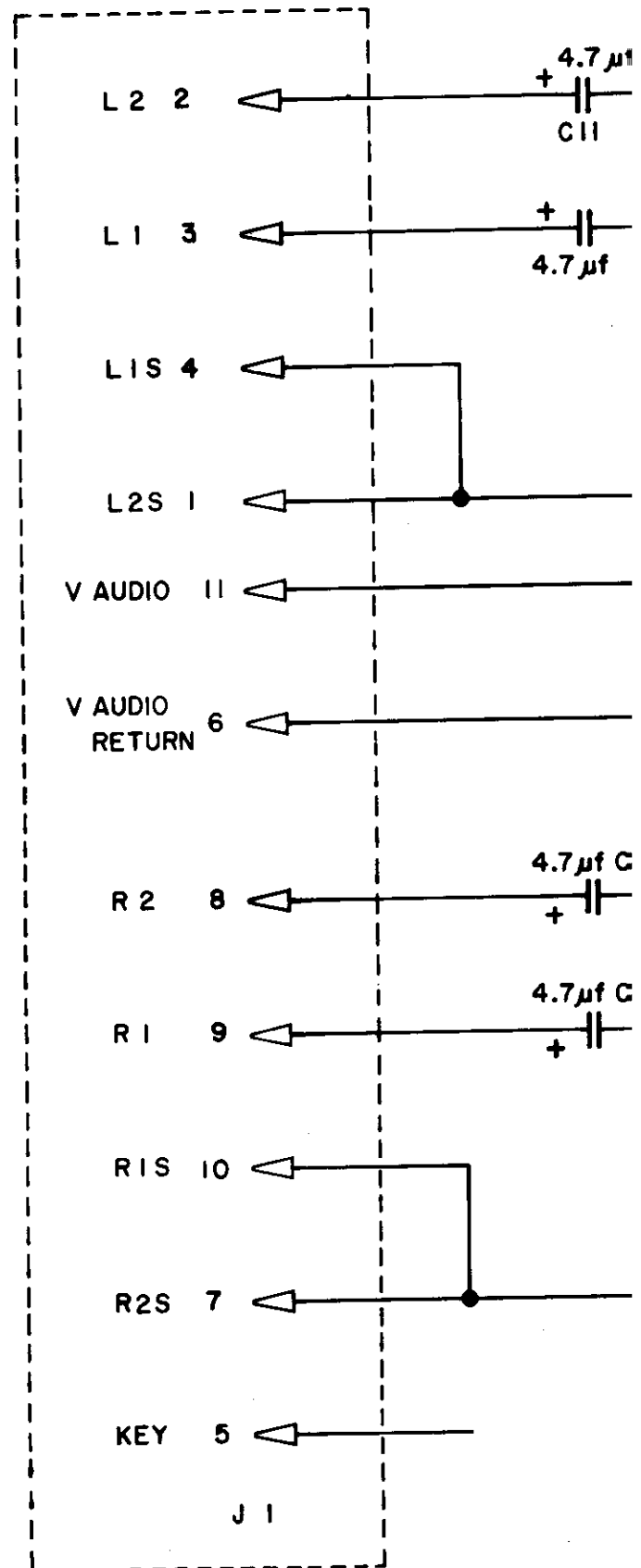

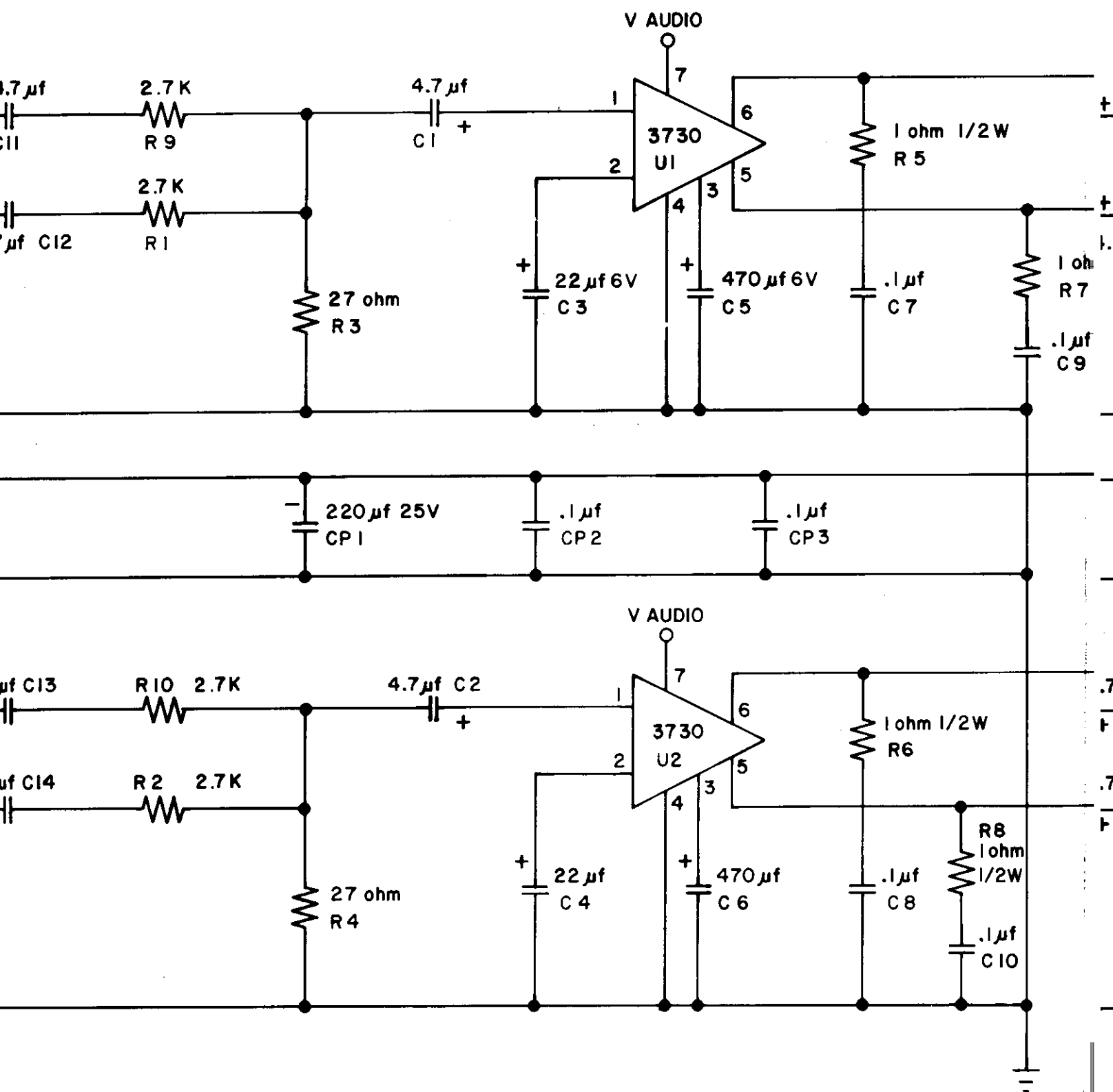

PROJECT ENG: CARY MEDNICK			USED ON	MCF
DO NOT SCALE DWG		HEAT TREAT	NO. REQ'D 1 P	
DIM TOLERANCES UNLESS SPECIFIED CONCENTRICITY TYP .005 FRACTIONAL .005 DECIMAL .005 HOLE DIA + .002 .000	DRN. / L L	MAT'L.	SCHEMATIC DRAWING DUAL PWR AMP W/MXR M A084-91648-A000	
	CKD.	FINISH		
	DATE 6/30/83			

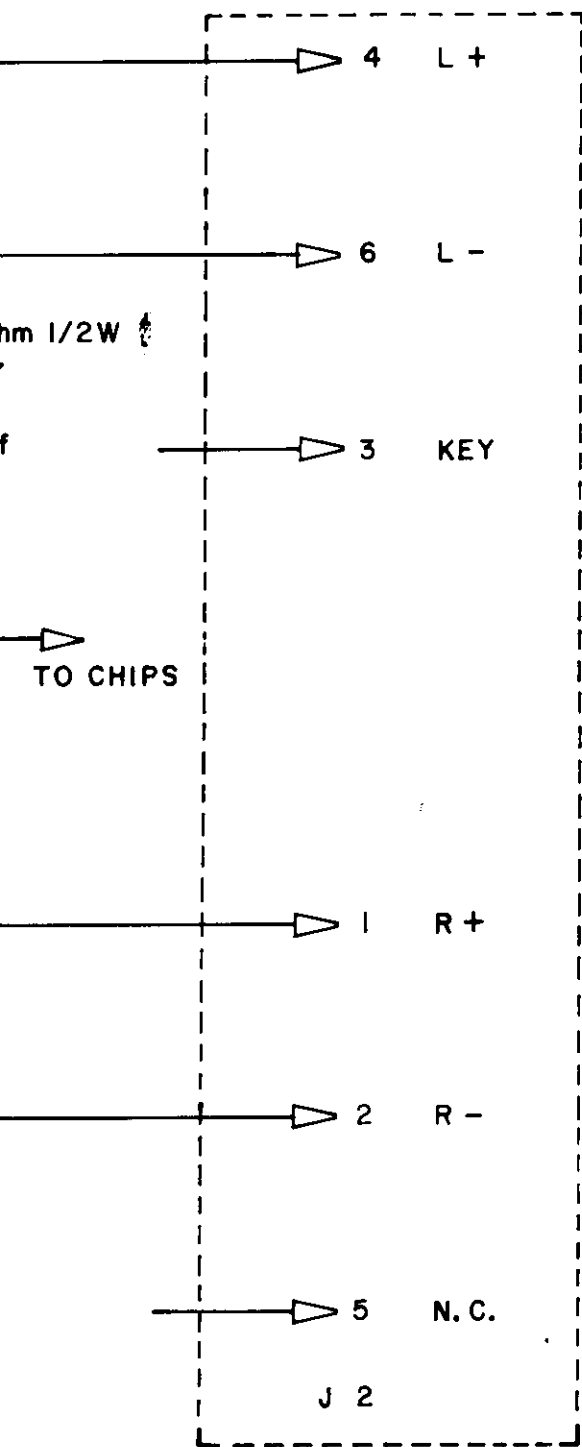

REVISIONS			
R/III		Bally / MIDWAY MFG. CO.	
PER		FRANKLIN PK ILL	
MCR III		PART NO.	
		M051 - 00304 - A013	

DESIGNATION LIST

<u>DESIGNATION NO.</u>	<u>DESCRIPTION</u>
C1,C2	4.7 MF 25V RD TANT.
C3,C4	22 MF 6V RD TANT.
C5,C6	470 MF 6V AX ELECT.
C7-C10	.1 MF 50V AX CR.
C11-C14	4.7 MF 25V RD TANT
CP1	220 MF 25V AX ELECT.
CP2,CP3	.1 MF 50V AX CR.
R1,R2	2.7K OHM 1/4W 5% CRBN.
R3,R4	27 OHM 1/4W 5% CRBN.
R5-R8	1 OHM 1/2W 5% CRBN.
R9,R10	2.7K OHM 1/4W 5%
U1,U2	MB3730
J1	.045 SQ. PIN
J2	.045 SQ. PIN
HSU1,U2	HEATSINK ASSY
MH1-MH4	1/4" SPACER FOR #8 SCREW
DUAL PWR AMP W/MXR	A080-91648-A000

CROSS REF

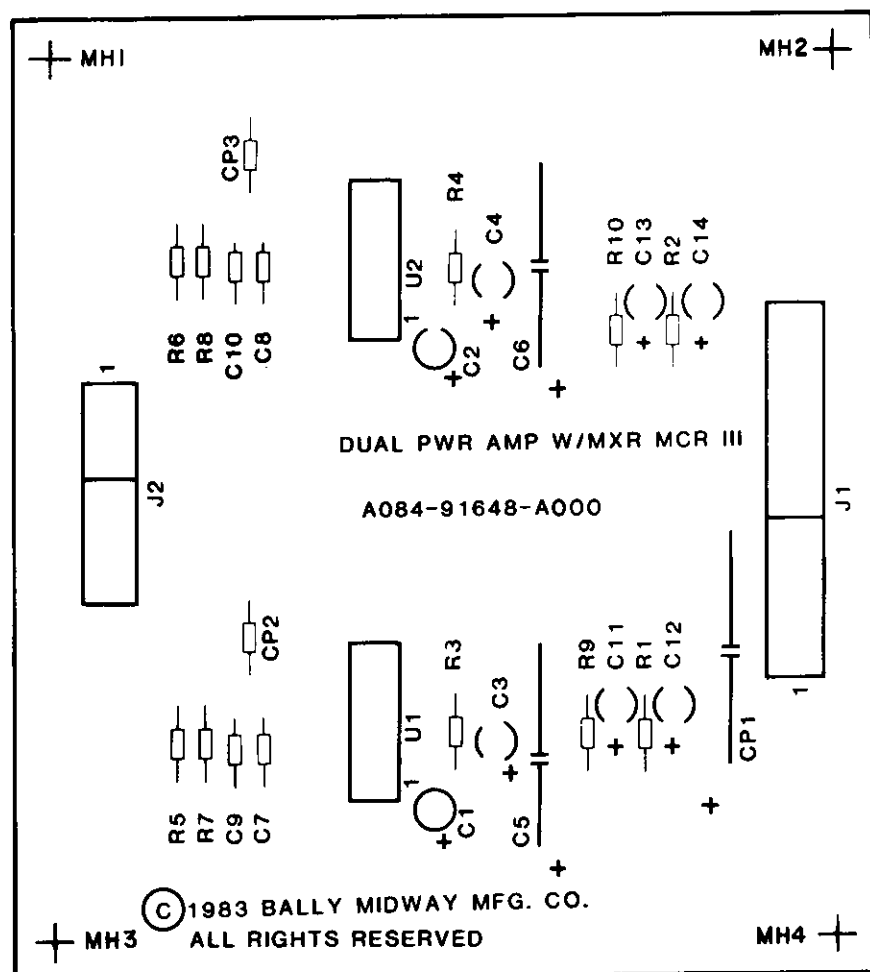

DESCRIPTION

QTY

DE

.1 MF 50V AX CR.
4.7 MF 25V RD
TANT.
22 MF 6V RD TANT
220 MF 25V AX
ELECT.
470 MF 6V AX
ELECT.

6
6

C7
C1

1 OHM 1/2W 5%
27 OHM 1/4W 5%
2.7K 1/4W 5%

4
2
4

R5
R3
R1

MB3730

2

U1

.045 SQ. PIN

5

J2

.045 SQ. PIN

10

J1

HEATSINK ASSY

2

HS

1/4" SPACER FOR
#8 SCREW

4

MH

DUAL PWR AMP
W/MXR

1

PROJECT ENG: C. MEDNICK			USED ON MCR II	
DO NOT SCALE DWG.		HEAT TREAT	SCALE FULL	NO. REQ'D 1 PER
DIM TOLERANCES UNLESS SPECIFIED	DRN. RLW	ASSEMBLY DWG. DUAL POWER AMP W/ MIXE A080-91648-A000		
	CKD.			
	DATE 07/05/83			

REFERENCE LIST

<u>DESIGNATION NO.</u>	<u>PART NOS.</u>
7-C10, CP2, CP3	0986-00800-1100
1, C2, C11-C14	0986-00800-3100
3, C4	0986-00800-1600
P1	0986-00800-3200
5, C6	0986-00800-1700
5-R8	0062-02603-1XXX
3, R4	0062-068B3-1XXX
1, R2, R9, R10	0062-199B3-1XXX
1, U2	0066-188XX-XX4X
2	0017-00033-0480
1	0017-00033-0480
SU1, HSU2	A986-00010-0000
11-MH4	0017-00042-0320
	A080-91648-A000

REVISIONS

I	Bally / MIDWAY MFG. CO. FRANKLIN PK ILL.

R MCR III	PART NO. M051 - 00304 - A012
-----------	---------------------------------

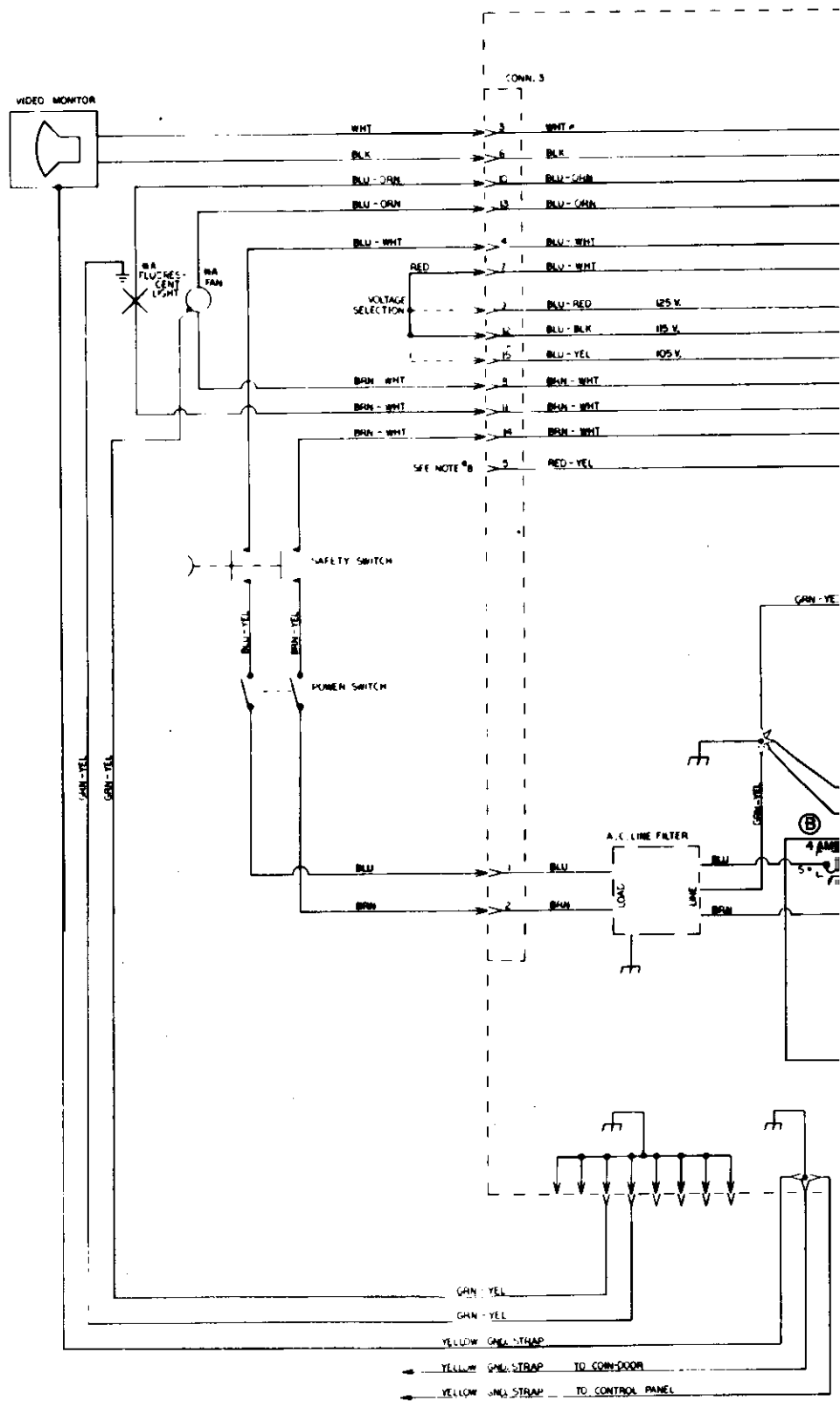

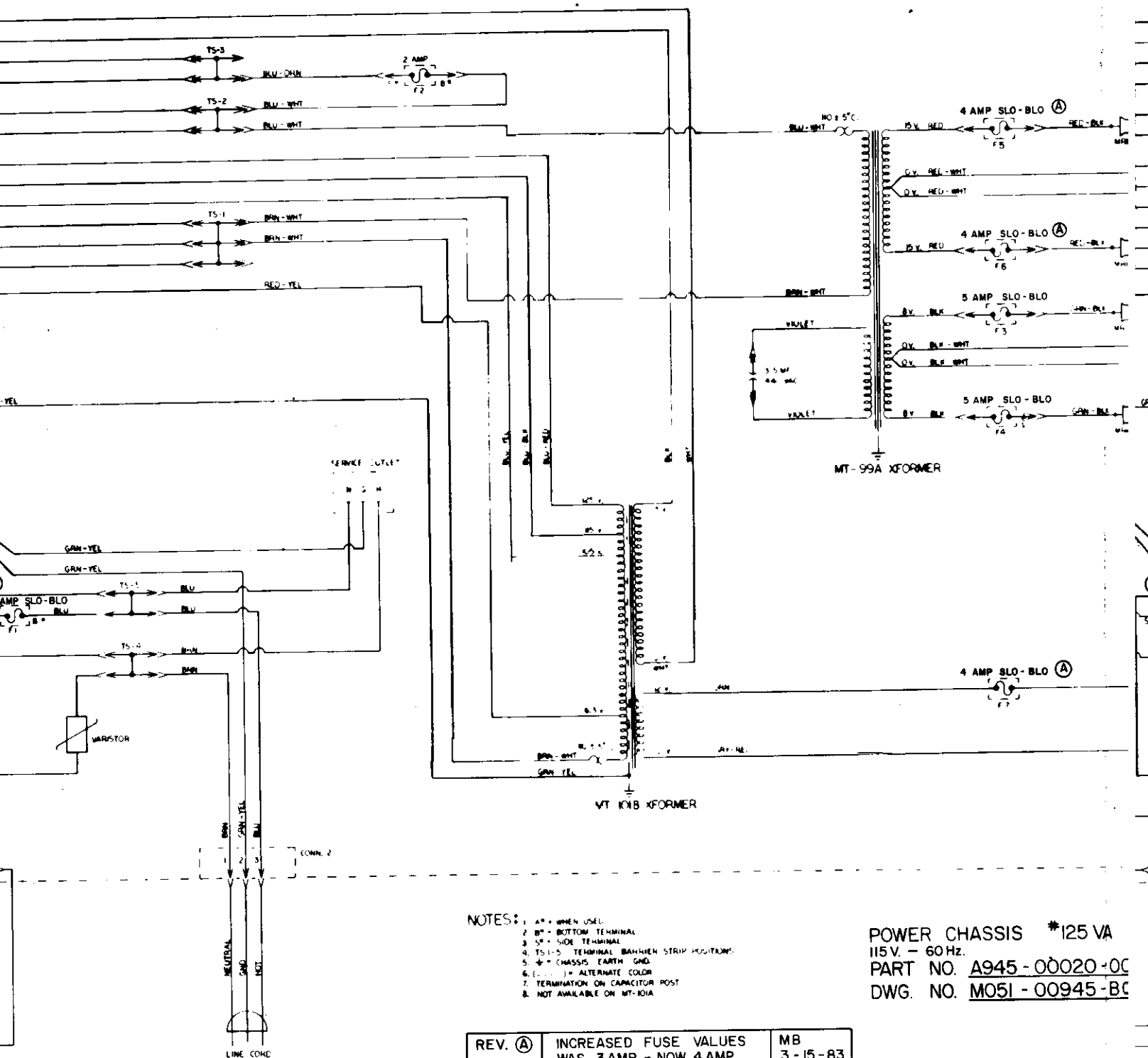

- NOTES:
1. A* - WHEN USED.
 2. B* - BOTTOM TERMINAL.
 3. S* - SIDE TERMINAL.
 4. TS 1-5 - TERMINAL BANQUET STRIP POSITION.
 5. + - CHASSIS EARTH GND.
 6. (---) - ALTERNATE COLOR.
 7. TERMINATION ON CAPACITOR POST.
 8. NOT AVAILABLE ON MT-101A.

POWER CHASSIS *125 VA
115V. - 60HZ.
PART NO. A945-00020-00
DWG. NO. M051-00945-B0

REV. A	INCREASED FUSE VALUES WAS 3 AMP - NOW 4 AMP ADDED PART NO. (UL)	MB 3-15-83
REV. B	INCREASED FUSE VALUE WAS 3AMP - NOW 4AMP	MB 3-24-83

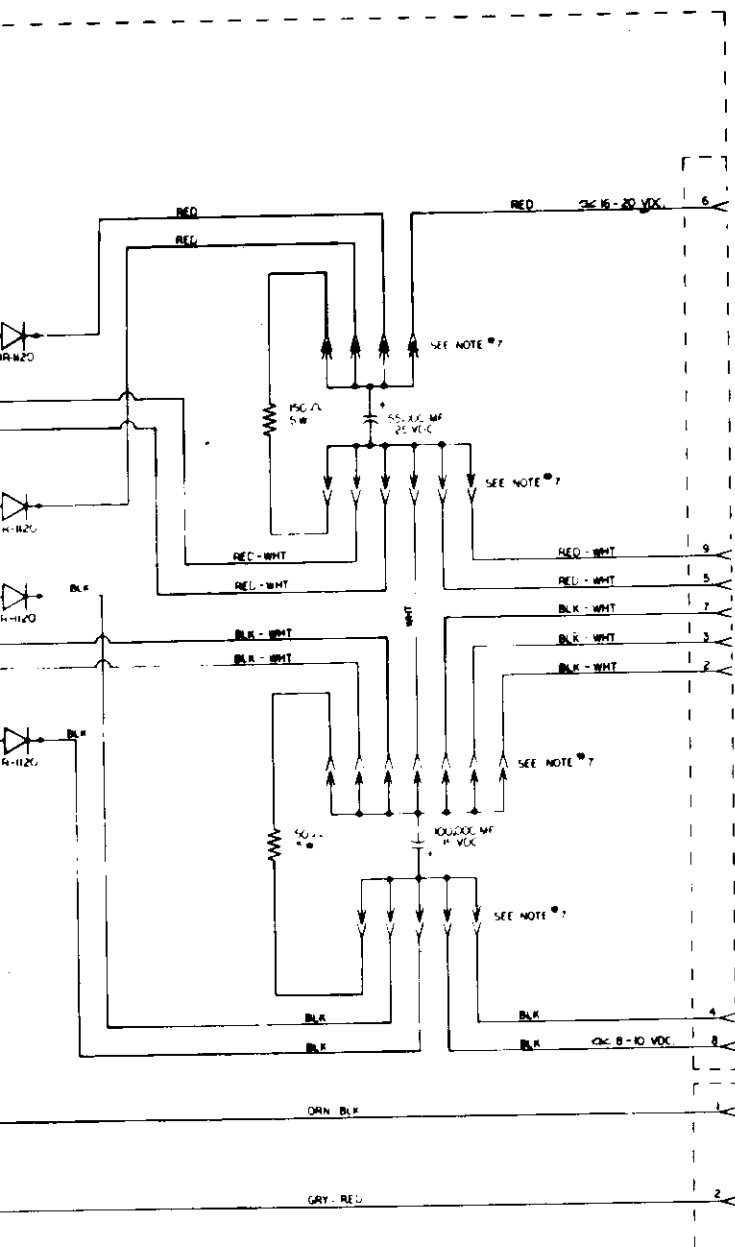

BALLY / MIDWAY
10601 W. BELMONT AVE.
FRANKLIN PARK, IL. 60131

000
037

DESIGNATION LIST

DESIGNATION *

DESCRIPTION

C101 4700uf AX. ELECT.
 C102 470uf AX. ELECT.
 C103 .10uf AX. CER.
 C104 .1uf AX. CER.
 C105 47pf AX. CER.
 C106 470uf AX. ELECT.
 C107 100uf RD. TANT.
 C108 1uf RD. TANT.
 C109 4.7uf RD. TANT.
 C110 .1uf AX. CER.
 C111 .1uf AX. CER.
 C201 .01uf MYLAR
 C202 .033uf MYLAR
 C203 .01uf MYLAR
 C204 .047uf MYLAR
 C205 820pf AX. CER.
 C206 C208 .01uf AX. CER.
 C207 0.082uf MYLAR

CP1 .1uf AX. CER.

R101 18ohm 5W W/RES. SPACER
 R102 68ohm 1/2W 5%
 R104 10ohm 5W W/RES. SPACER
 R105 27ohm 1/4W 5%
 R106 270ohm 1/4W 5%
 R107 6.2K 1/4W 5%

R109 1K 1/4W 5%
 R110 .16ohm 15W W/RES. SPACER
 R111 6.8ohm 1/2W 5%
 R112 68ohm 1/2W 5%
 R113 1.2K 1/4W 5%
 R114 47ohm 1/4W 5%
 R115 160ohm 1/4W 5%

R117 560ohm 1/4W 5%
 R118 150ohm 2W
 R201 270ohm 1/4W 5%
 R202 1.2K 1/4W 5%
 R203 1.1M 1/4W 5%
 R204 3.3M 1/4W 5%
 R205 10M 1/4W 5%
 R206 100K 1/4W 5%
 R207 33K 1/4W 5%
 R208 2M 1/4W 5%
 R209 1M 1/4W 5%
 R210 1.2M 1/4W 5%
 R211 75K 1/4W 5%
 R212 75K 1/4W 5%
 R213 220K 1/4W 5%
 R214 3.9K 1/4W 5%
 R215 1.2K 1/4W 5%
 R216 82ohm 1W 10%
 R217 270ohm 1/4W 5%
 R218 110K 1/4W 5%
 R219 68ohm 1/2W 5%

VR101,102 100ohm POT

DESIGNATION *

DESCRIPTION

D101 A15F
 D102 A15F
 D103 A15F
 D104 A15F
 D105 A15F
 D106 1N4001
 D201 1N4148
 D202 1N4148
 D203 1N4148
 D204 1N4001
 D205 1N4001

Q102 2N2905
 Q105 2N2905
 Q201 2N4401

U1 LM305 REG.
 U2 LM305 REG.
 U3 LM3900
 U4 AN28
 U6 555

L101 22uH INDUCTOR

B101 BATTERY 3.6VDC 60DEG C

F1 3 BA S BLO FUSE

FC1A,1B FUSE CLIP

FE1,2 FERRITE BEAD

TW1 TIE WRAP

J3 9PIN P.C. MOUNT CONN.(MALE)
 J4 15PIN P.C. MOUNT CONN.(FEMALE)
 J5 15PIN P.C. MOUNT CONN.(MALE)
 J6 3PIN P.C. MOUNT CONN.(MALE)

LB1 FUSE TAG

LB2 SYSTEM TAG

HSA1 HEAT SINK ASS'Y 1

MHSA1 MOUNTING HARD WARE(HEAT SINK)
 2 SCREW
 4 WASHER
 2 HEXNUT

JW1-5 JUMPER WIRE

FBMH1,2 FERRITE BEAD MOUNTING HARDWARE

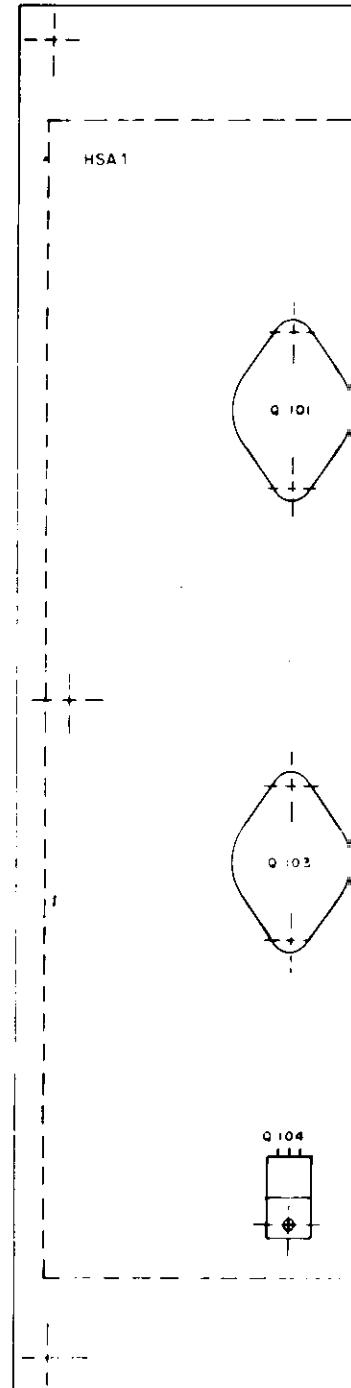

CROSS REFERENCE LIST

PART *	DESCRIPTION	Q'ty	DESIGNATION *	PART *
0945-00811-0100	LM305 REG.	2	U1,2	0945-00813-0100
0945-00816-0400	555	1	U6	0929-00810-4500
0945-00816-0100	LM3900	1	U3	0945-00813-0200
0945-00816-0200	4N28	1	U4	0945-00813-0300
0945-00816-0500				
0945-00816-0300				
0945-00816-1900	A15F RECTIFIER	5	D101-105	0945-00804-0200
0945-00811-0200				
0945-00811-0300	1N4001	3	D106,204,205	0945-00804-0300
0945-00811-0400	1N4148	3	D201-203	0945-00804-0500
0945-00811-0500				
0945-00816-0600	2N2905	2	Q102,105	0945-00808-0300
0945-00811-0700	2N4401	1	Q201	0945-00804-0400
0945-00815-0100	BATTERY 3.6VDC 60DEG-C	1	B101	0017-00003-0377
0945-00815-0200	FUSE 3/8A S-BLO	1	F1	0945-00808-0400
0062-04703-1XXX	FUSE CLIP	2	FC1A,1B	0017-00003-0214
0945-00812-0100	TIE WRAP	1	TW1	0945-00814-0300
0062-068B3-1XXX	FERRITE BEAD	2	FB1,2	0017-00009-0225
0062-086B3-1XXX	FERRITE MOUNTING HDW.	2	FBMH1,2	0017-00033-0139
0062-098D3-1XXX				
0062-104F5-1XXX				
0945-00812-0200	22uH INDUCTOR	1	L101	0945-00814-0200
0062-124B3-1XXX	FUSE TAG	1		M051-00945-A004
0062-138B3-1XXX	SYSTEM TAG	1		M051-00945-A009
0062-162B3-1XXX	P.C.B.	1		A080-90412-0000
0062-179B3-1XXX				
0062-183B3-1XXX				
0062-207B3-1XXX				
0062-217B3-1XXX				
0062-251B3-1XXX	HEAT SINK ASS'Y	1	HSA1	A945-00008-0000
0062-269B3-1XXX	(SEE HS ASS'Y DRAWING "XX NOTE")			
0062-275B3-1XXX	4-40X10 SLT RND	2	MH HSA1A,2A.	0017-00101-00727
0062-277B3-1XXX	4-40 HEX NUT	2	MH HSA1E, 2E.	0017-00103-0002
0062-291B3-1XXX	WSH 4-120-.250-018	4	MH HSA1B,1D	0017-00104-0071
0062-323B3-1XXX			MH HSA2B,2D	
0062-325B3-1XXX				
0062-327B3-1XXX	3PIN P.C. MOUNT CONN. (MALE)	1	J6	0017-00021-0443
0062-337B3-1XXX	9PIN P.C. MOUNT CONN. (MALE)	1	J3	0017-00021-0425
0062-347B3-1XXX	15PIN P.C. MOUNT CONN. (FEMALE)	1	J4	0017-00021-0441
0062-371B3-1XXX	15PIN P.C. MOUNT CONN. (MALE)	1	J5	0017-00021-0440
0945-00814-0000	22AWG T & R BARE 2.5"	5	JW1-5	0151-00087-0000

FROJ. ENG.: L. DEKKER		SATAN'S HOLLOW		MIDWAY MFG. CO.	
DO NOT SCALE DIMS		FULL		FRANKLIN PK. ILL.	
DATE: 5/17/82		ASSEMBLY DRAWING (25VA PWRSPY)		PART NO: M051-00945-D006	
A082-90412-D000					

BALLY/MIDWAY'S TAPPER
U.R. #A11
ROM/EPROM PART NUMBERS

UNPROGRAMED SUPER VIDEO GEN. A084-91464-L000
PROGRAMED SUPER VIDEO GEN. A084-91464-AA11

POS.	MIDWAY PART NUMBER
1A	0A11-00803-0001
2A	0A11-00803-0002
3A	0A11-00803-0003
4A	0A11-00803-0004
5A	0A11-00803-0005
6A	0A11-00803-0006
7A	0A11-00803-0007
8A	0A11-00803-0008

JUMPERS	IN	OUT
JW1		**
JW2	**	

UNPROGRAMED 5 MHZ CPU A084-91490-H000
PROGRAMED 5 MHZ CPU A084-91490-AA11

POS.	MIDWAY PART NUMBER
5F	0A11-00803-0013
6F	0A11-00803-0014
1C	0A11-00803-0009
2C	0A11-00803-0010
3C	0A11-00803-0011
4C	0A11-00803-0012

JUMPERS	IN	OUT
JW1		**
JW2		**
JW3	**	
JW4		**
JW5		**
JW6		**

UNPROGRAMED S/S I/O A084-90913-G000
PROGRAMED S/S I/O A084-90913-AA11

POS.	MIDWAY PART NUMBER
7A	0A11-00803-0015
8A	0A11-00803-0016
9A	0A11-00803-0017
10A	0A11-00803-0018

EPROM	JUMPERS	IN	OUT
2532	JW1		**
2532	JW2	**	
2732	JW1	**	
2732	JW2		**

REVISIONS		
12/19/83	RELEASE FOR PRODUCTION	